

MEM Wall-mounted three-hole lavatory mixer without drain - Chrome

MEM

36 712 782 Product version from 7/1/2016 to 10/27/2020



- 7-7/8" Projection
- Rigid spout
- Rectangular aerated stream
- Valve hole diameter 1-5/8"
- Spout hole diameter 1-5/8"
- Individual flanges 2-3/8" x 2-3/8"
- Water flow rate limited to max. 1.2 gpm
- lead-free
- This product can help a building meet the requirements of Green Building Rating Systems, e.g. LEED®, BREEAM®, DGNB **(ADA)**

(ADA)

| | | |
|---|-------------------------------|--------------------|
|  | Chrome | 36 712 782-00 0010 |
|  | Brushed Platinum | 36 712 782-06 0010 |
|  | Platinum | 36 712 782-08 0010 |
|  | Dark Chrome | 36 712 782-19 0010 |
|  | Brushed Durabrass (23kt Gold) | 36 712 782-28 0010 |
|  | Brushed Champagne (22kt Gold) | 36 712 782-46 0010 |
|  | Champagne (22kt Gold) | 36 712 782-47 0010 |
|  | Brushed Dark Platinum | 36 712 782-99 0010 |

Required article



- Rough for wall-mounted faucet , spout in center -** 35 700 970-90 0010
- Max. rough in depth 5-7/8"
 - Min. rough in depth 4-3/8"

Required article



- Rough for wall-mounted faucet flexible positioning -** 35 720 970-90 0010
- Max. rough in depth 5-7/8"
 - Min. rough in depth 4-3/8"

MEM Wall-mounted three-hole lavatory mixer without drain - Chrome

MEM

36 712 782 Product version from 7/1/2016 to 10/27/2020

mm [inches]

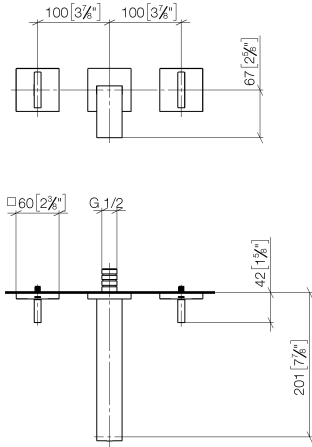

Codes & Standards

| | | | |
|----------------|----------------|------------------------------------|------------|
| ADA | ASME A112.18.1 | California Energy Commission (CEC) | cUPC |
| EPA WaterSense | NSF372 | NSF61 | WaterSense |



Certificates and sustainability

| | | | |
|--------------|------------|--------------|------------|
| IAPMO_N-4976 | IAPMO_6397 | IAPMO_4976 (| IAPMO_8834 |
|--------------|------------|--------------|------------|

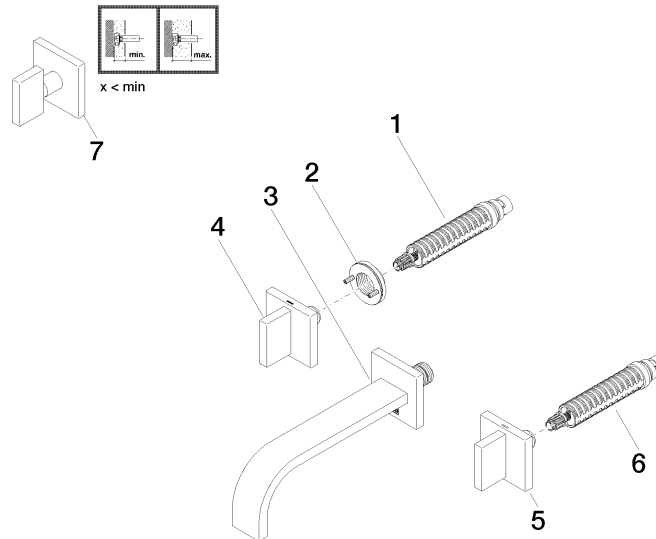

Spare parts list

| Number | Item Number | Designation | Number of units | Lead time |
|--|--------------------|---|-----------------|-----------|
| 4 | 90 20 78 002 07-00 | handle (hot) | 1.00 | 10 |
| 3 | 13 800 782-00 0010 | MEM Lavatory spout, wall-mounted without drain - Chrome | 1.00 | - |
| Spare part can no longer be ordered, please order the replacement item | | | | |
| 5 | 90 20 78 002 06-00 | handle (cold) | 1.00 | 10 |
| 2 | 90 21 02 108 00 90 | disc | 1.00 | 2 |
| 6 | 90 90 03 157 00 90 | top | 1.00 | 2 |
| 1 | 90 90 03 156 00 90 | top | 1.00 | 2 |
| 7 | 90 20 78 002 01-00 | handle | 1.00 | 10 |