

## MEM Wall-mounted three-hole lavatory mixer without drain - Brushed Dark Platinum

MEM

36 712 782 Product version from 7/1/2016 to 10/27/2020



- 7-7/8" Projection
- Rigid spout
- Rectangular aerated stream
- Valve hole diameter 1-5/8"
- Spout hole diameter 1-5/8"
- Individual flanges 2-3/8" x 2-3/8"
- Water flow rate limited to max. 1.2 gpm
- lead-free
- This product can help a building meet the requirements of Green Building Rating Systems, e.g. LEED®, BREEAM®, DGNB

**(ADA)**

(ADA)

	Brushed Dark Platinum	36 712 782-99 0010
	Chrome	36 712 782-00 0010
	Brushed Platinum	36 712 782-06 0010
	Platinum	36 712 782-08 0010
	Dark Chrome	36 712 782-19 0010
	Brushed Durabronze (23kt Gold)	36 712 782-28 0010
	Brushed Champagne (22kt Gold)	36 712 782-46 0010
	Champagne (22kt Gold)	36 712 782-47 0010

### Required article



- Rough for wall-mounted faucet , spout in center -** 35 700 970-90 0010
- Max. rough in depth 5-7/8"
  - Min. rough in depth 4-3/8"

### Required article



- Rough for wall-mounted faucet flexible positioning -** 35 720 970-90 0010
- Max. rough in depth 5-7/8"
  - Min. rough in depth 4-3/8"



MEM Wall-mounted three-hole lavatory mixer without drain - Brushed Dark Platinum

MEM

36 712 782 Product version from 7/1/2016 to 10/27/2020  
mm [inches]

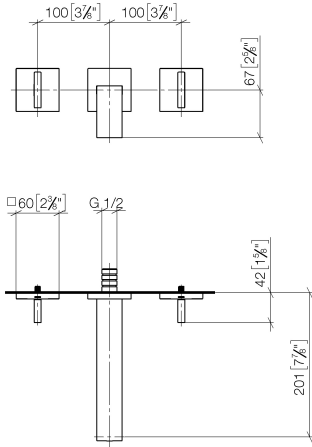

Codes & Standards

ADA	ASME A112.18.1	California Energy Commission (CEC)	cUPC
EPA WaterSense	NSF372	NSF61	WaterSense



Certificates and sustainability

IAPMO_N-4976	IAPMO_6397	IAPMO_4976 (	IAPMO_8834
--------------	------------	--------------	------------

# MEM Wall-mounted three-hole lavatory mixer without drain - Brushed Dark Platinum

MEM

36 712 782 Product version from 7/1/2016 to 10/27/2020

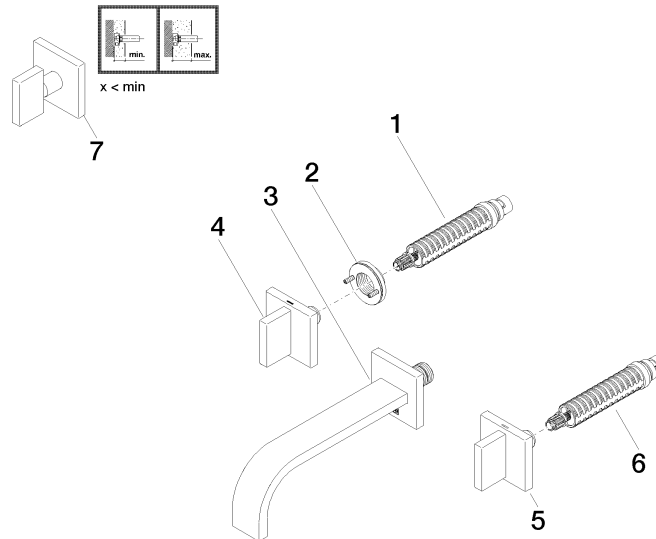

## Spare parts list

Number	Item Number	Designation	Number of units	Lead time
6	90 90 03 157 00 90	top	1.00	2
1	90 90 03 156 00 90	top	1.00	2
3	13 800 782-99 0010	MEM Lavatory spout, wall-mounted without drain - Brushed Dark Platinum	1.00	-
Spare part can no longer be ordered, please order the replacement item				
2	90 21 02 108 00 90	disc	1.00	2
5	90 20 78 002 06-99	handle ( cold )	1.00	20
4	90 20 78 002 07-99	handle ( hot )	1.00	20
7	90 20 78 002 01-99	handle	1.00	20