

## VAIA Lavatory Touchfree Faucet without drain - Matte Black

VAIA

44 521 809 Product version from 4/1/2025



- Infrared sensor technology
- 6-5/8" Projection
- Total height 12"
- Height to aerator/spout outlet 8-3/4"
- 1-3/8" hole diameter
- Rigid spout
- Water flow rate limited to max. 0.5 gpm
- Laminar stream
- Thermal disinfection
- Automatic shut-off after 30 seconds
- Indirect temperature control (undercounter)
- Control box included
- Adjustable sensor detection range
- Battery or plug-in power supply operated (batteries not included)
- 4x AA (1.5V) batteries required
- lead-free
- 1x 3/8" flexible supply line
- This product can help a building meet the requirements of Green Building Rating Systems, e.g. LEED®, BREEAM®, DGNB

Batteries not included

NOTE: A tempering device is recommended for installation in public areas. Please refer to your local building codes.

|   |                                |                    |
|---|--------------------------------|--------------------|
|    | Matte Black                    | 44 521 809-33 0010 |
|    | Chrome                         | 44 521 809-00 0010 |
|    | Brushed Platinum               | 44 521 809-06 0010 |
|    | Platinum                       | 44 521 809-08 0010 |
|    | Dark Chrome                    | 44 521 809-19 0010 |
|    | Brushed Durabronze (23kt Gold) | 44 521 809-28 0010 |
|    | Brushed Dark Brass             | 44 521 809-39 0010 |
|    | Brushed Bronze                 | 44 521 809-42 0010 |
|    | Brushed Champagne (22kt Gold)  | 44 521 809-46 0010 |
|   | Champagne (22kt Gold)          | 44 521 809-47 0010 |
|  | Brushed Chrome                 | 44 521 809-93 0010 |
|  | Brushed Dark Platinum          | 44 521 809-99 0010 |

44 521 809 Product version from 4/1/2025

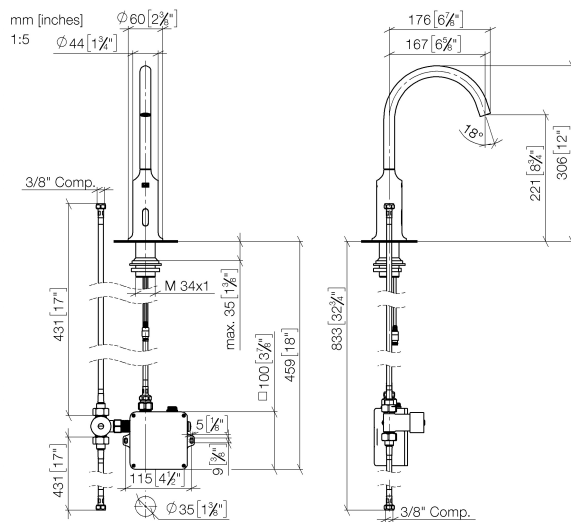

## Codes & Standards

|                |                                    |      |        |
|----------------|------------------------------------|------|--------|
| ASME A112.18.1 | California Energy Commission (CEC) | cUPC | NSF372 |
|----------------|------------------------------------|------|--------|

## Certificates and sustainability

IAPMO\_6397 IAPMO\_4976 (

Parts for other  
finishes can be found  
here: [Chrome](#)

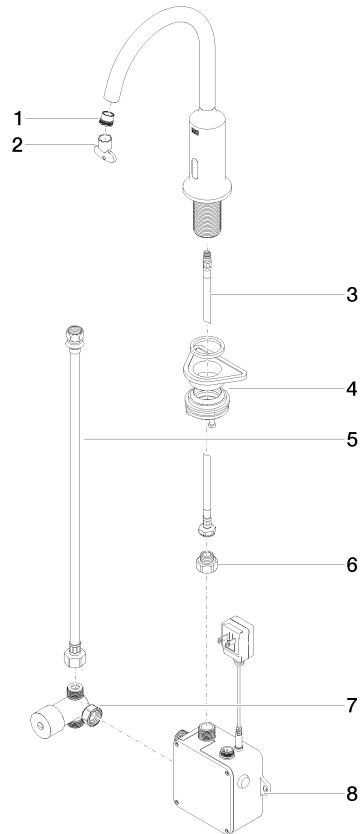

## Spare parts list

| Number | Item Number        | Designation           | Number of units | Lead time |
|--------|--------------------|-----------------------|-----------------|-----------|
| 4      | 04 23 10 044 08 90 | fixing set            | 1.00            | 2         |
| 6      | 09 24 03 185-00    | nipple                | 1.00            | 10        |
| 1      | 09 29 03 094 90    | aerator               | 1.00            | 2         |
| 5      | 12 506 970 90      | High pressure hoses - | 1.00            | 2         |
| 7      | 90 30 50 081 00 90 | valve                 | 1.00            | 2         |
| 8      | 90 10 01 247 02 90 | valve box             | 1.00            | 60        |
| 3      | 04 30 04 100 00 90 | hose                  | 1.00            | 2         |
| 2      | 90 30 09 028 00 90 | key                   | 1.00            | 2         |