

Towel bar - Matte Black

SERIES SPECIFIC

83 080 979 Product version from 7/1/2023



- Center to center 31-1/2"
- Width 33-1/8"
- Height 1-5/8"
- Flange diameter 1-5/8"
- 2-1/2" Projection

Fits ELIO, ENO, MEM, META SQUARE, SYNC and TARA ULTRA

	Matte Black	83 080 979-33
	Chrome	83 080 979-00
	Brushed Platinum	83 080 979-06
	Dark Chrome	83 080 979-19
	Brushed Durabrass (23kt Gold)	83 080 979-28
	Brushed Champagne (22kt Gold)	83 080 979-46
	Champagne (22kt Gold)	83 080 979-47
	Brushed Chrome	83 080 979-93
	Brushed Dark Platinum	83 080 979-99

Towel bar - Matte Black

SERIES SPECIFIC

83 080 979 Product version from 7/1/2023

mm [inches]

M 1:10

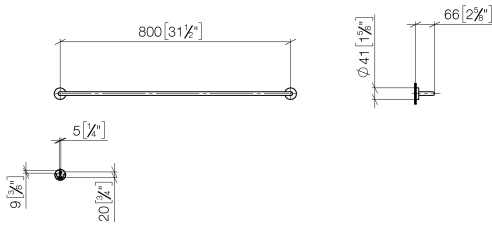

Towel bar - Matte Black

SERIES SPECIFIC

83 080 979 Product version from 7/1/2023

Parts for other
finishes can be found
here: [Chrome](#)

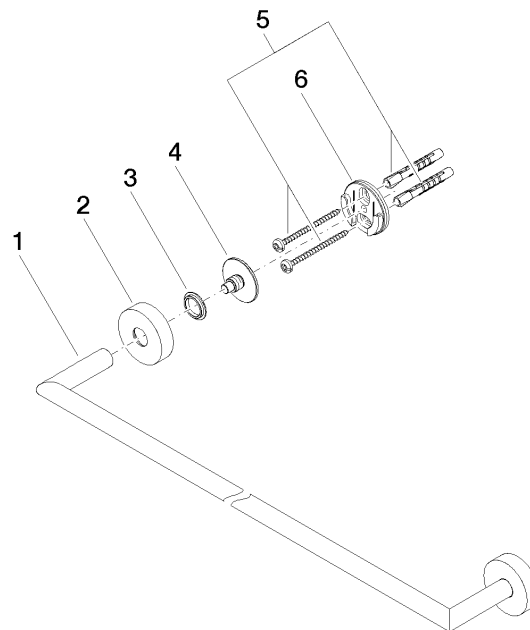

Spare parts list

Number	Item Number	Designation	Number of units	Lead time
6	08 17 97 501 07	holder	2.00	2
2	08 27 97 500-33	rosette	2.00	30
5	05 30 31 025 00 90	fixing set	2.00	2
3	08 30 11 516 90	ring	2.00	2
4	08 17 97 560 90	holder	2.00	2
1	05 28 22 623 00-33	holder	1.00	30