

Hook - Chrome

SERIES SPECIFIC

83 251 979    Product version from 7/1/2023



- Flange diameter 1-5/8"
- 2" Projection

Fits ELIO, ENO, MEM, META SQUARE, SYNC, TARA  
and TARA ULTRA

	Chrome	83 251 979-00
	Brushed Platinum	83 251 979-06
	Dark Chrome	83 251 979-19
	Brushed Durabronze (23kt Gold)	83 251 979-28
	Matte Black	83 251 979-33
	Brushed Champagne (22kt Gold)	83 251 979-46
	Champagne (22kt Gold)	83 251 979-47
	Brushed Chrome	83 251 979-93
	Brushed Dark Platinum	83 251 979-99

83 251 979 Product version from 7/1/2023

mm [inches]



Parts for other  
 finishes can be found  
 here: Brushed  
 Platinum

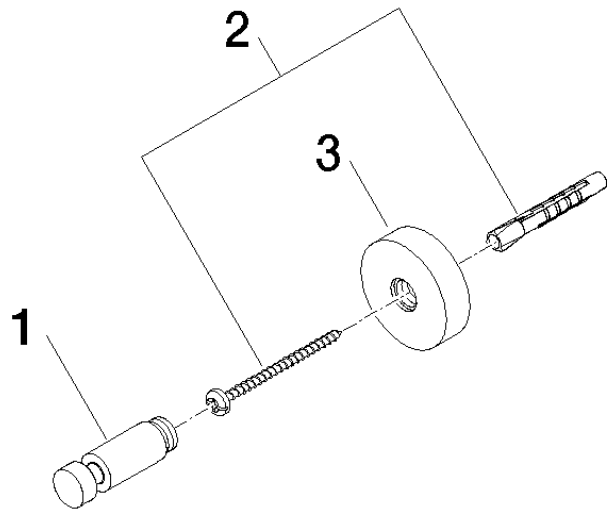

Spare parts list

Number	Item Number	Designation	Number of units	Lead time
2	05 30 31 025 00 90	fixing set	1.00	2
1	08 18 60 518-00	hook	1.00	10
3	08 27 97 501-00	rosette	1.00	10