

WATER TUBE Kneipp wall elbow - Brushed Platinum

ST 050 608 3979



- LAMINAR FLOW, max. flow rate 4 gpm (at 3 bar)
- with volume control
- Individual flanges 2-3/8" x 2-3/8"
- Bracket for Kneipp hose
- 1/2" wall elbow
- Hose nozzle with sleeve
- With holding ring

	Brushed Platinum	ST 050 608 3979-06
	Chrome	ST 050 608 3979-00
	Platinum	ST 050 608 3979-08
	Dark Chrome	ST 050 608 3979-19
	Brushed Light Gold	ST 050 608 3979-27
	Brushed Durabronze (23kt Gold)	ST 050 608 3979-28
	Matte Black	ST 050 608 3979-33
	Brushed Champagne (22kt Gold)	ST 050 608 3979-46
	Champagne (22kt Gold)	ST 050 608 3979-47
	Brushed Chrome	ST 050 608 3979-93
	Brushed Dark Platinum	ST 050 608 3979-99

Individual components of this set

The following components are needed for this set



1x 27 821 979-06



1x 28 285 979-06



## WATER TUBE Kneipp wall elbow - Brushed Platinum

---

ST 050 608 3979

# WATER TUBE Kneipp wall elbow - Brushed Platinum

ST 050 608 3979





- LAMINAR FLOW, max. flow rate 4 gpm (at 3 bar)
- with volume control
- Flange 2-3/8" x 2-3/8"
- Bracket for Kneipp hose
- 1/2" wall elbow
- Hose to be ordered separately

**Internal backflow preventer.**

**Product change as of 1.4.2023: Water flow rate limited to max. 4 gpm**

Internal backflow preventer.

Product change as of 1.4.2023: Water flow rate limited to max. 4 gpm

	Brushed Platinum	27 821 979-06
	Chrome	27 821 979-00
	Platinum	27 821 979-08
	Dark Chrome	27 821 979-19
	Brushed Light Gold	27 821 979-27
	Brushed Durabronze (23kt Gold)	27 821 979-28
	Matte Black	27 821 979-33
	Brushed Champagne (22kt Gold)	27 821 979-46
	Champagne (22kt Gold)	27 821 979-47
	Brushed Chrome	27 821 979-93
	Brushed Dark Platinum	27 821 979-99

## Required article



**Rough-in adapter -** 35 080 970-90 0010

## Required article



**WATER TUBE Kneipp hose black 78-3/4" - Brushed Platinum** 28 286 979-06  
 •With holding ring  
 •Hose nozzle with sleeve

## Required article



**WATER TUBE Kneipp hose white 78-3/4" - Brushed Platinum** 28 285 979-06  
 •With holding ring  
 •Hose nozzle with sleeve

# WATER TUBE Kneipp wall elbow - Brushed Platinum

ST 050 608 3979

mm [inches]

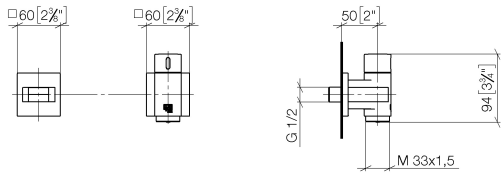

## Flow rate chart

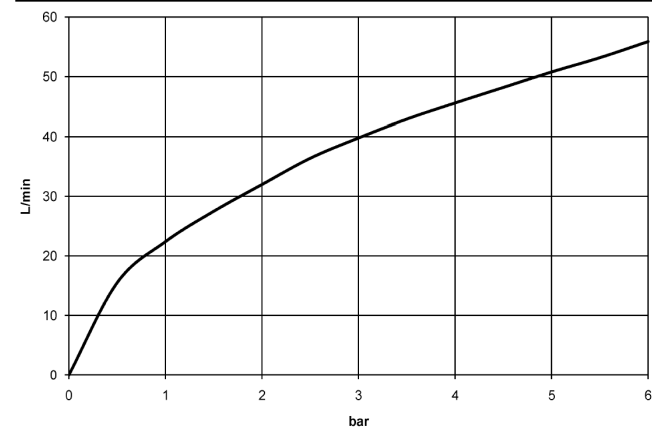

## Codes & Standards

EN 1717

## Certificates

Belgaqua\_22\_280\_2

## WATER TUBE Kneipp wall elbow - Brushed Platinum

---

ST 050 608 3979

## WATER TUBE Kneipp wall elbow - Brushed Platinum

ST 050 608 3979

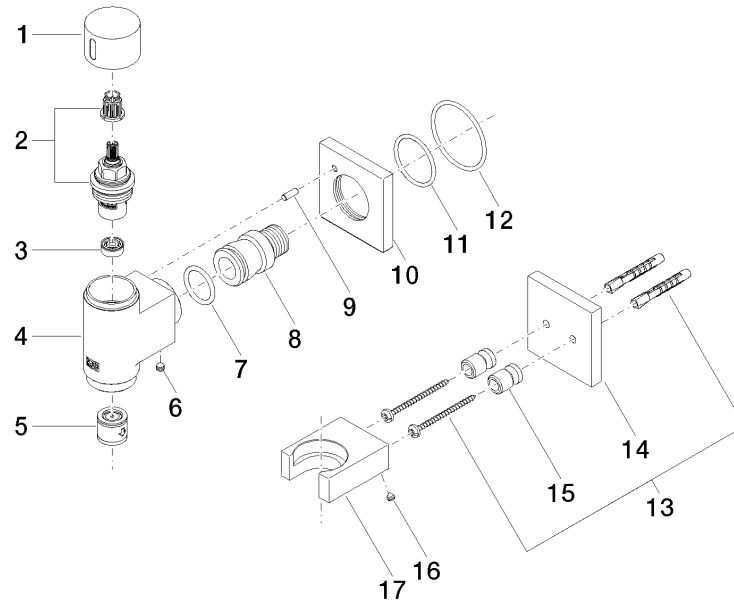

### Spare parts list











Number	Item Number	Designation	Number of units	Lead time
1	09 20 97 021-06	handle	1	10
2	90 90 03 145 00 90	top	1	2
3	90 23 01 146 00 90	flow reducer	1	2
4	09 11 03 135-06	connection	1	60
5	90 23 01 045 00 90	back-flow preventer	1	2
6	90 31 11 112 00 90	pin	1	2
7	09 14 10 081 90	seal	1	2
8	09 24 03 151 90	nipple	1	2
9	09 31 11 040 90	pin	1	2
10	09 27 97 021-06	rosette	1	10
11	09 14 10 119 90	seal	1	2
12	90 14 10 049 00 90	seal	1	2
13	05 30 31 025 00 90	fixing set	1	2
14	09 27 97 022-06	rosette	1	10
15	08 17 20 726 90	holder	2	2
16	09 31 11 148 90	pin	2	2
17	09 17 20 023-06	holder	1	10

# WATER TUBE Kneipp wall elbow - Brushed Platinum

ST 050 608 3979

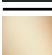

- Hose nozzle with sleeve
- With holding ring

	Brushed Platinum	28 285 979-06
	Chrome	28 285 979-00
	Platinum	28 285 979-08
	Dark Chrome	28 285 979-19
	Brushed Durabrass (23kt Gold)	28 285 979-28
	Matte Black	28 285 979-33
	Brushed Champagne (22kt Gold)	28 285 979-46
	Champagne (22kt Gold)	28 285 979-47
	Brushed Chrome	28 285 979-93
	Brushed Dark Platinum	28 285 979-99



## WATER TUBE Kneipp wall elbow - Brushed Platinum

---

ST 050 608 3979



# WATER TUBE Kneipp wall elbow - Brushed Platinum

ST 050 608 3979

mm [inches]

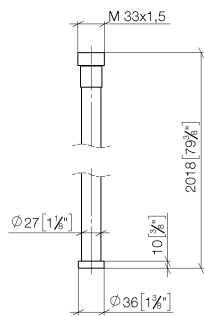

## Flow rate chart

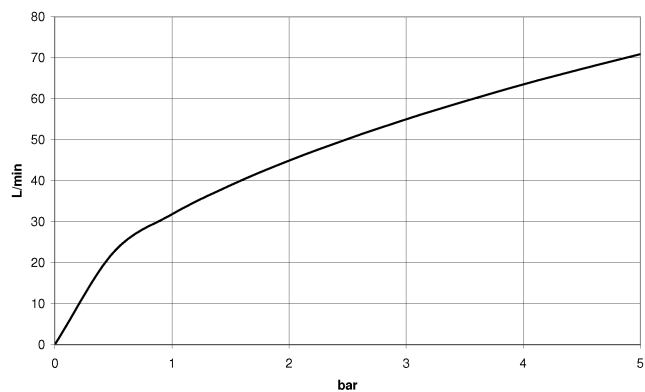

WATER TUBE Kneipp wall elbow - Brushed Platinum

ST 050 608 3979

Parts for other  
finishes can be found  
here: [Chrome](#)

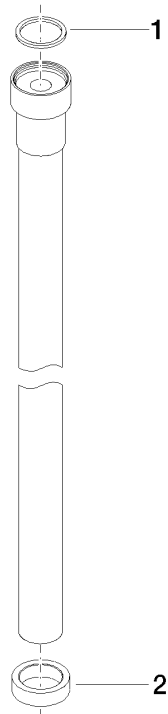

Spare parts list

Number	Item Number	Designation	Number of units	Lead time
1	09 14 20 003 90	seal	1	2
2	09 28 10 116-12	ring	1	30