

VAIA Single-lever mixer with side spray set - Brushed Champagne (22kt Gold)

ST 110 105 1809



- 8" Projection
- Swiveling spout 360°
- Aerated stream and spray mode
- Integrated diverter
- Total height 12-3/8"
- Height to aerator/spout outlet 8-1/2"
- Single-lever mixer hole diameter 1-3/8"
- Side spray hole diameter 1-1/4"
- 2 x pressure hose with 3/8" compression fitting
- Fabric braided spray hose 59"
- Sprayface with descaling system
- Water flow rate limited to max. 1.5 gpm
- lead-free
- This product can help a building meet the requirements of Green Building Rating Systems, e.g. LEED®, BREEAM®, DGNB

	Brushed Champagne (22kt Gold)	ST 110 105 1809-46 0010
	Chrome	ST 110 105 1809-00 0010
	Brushed Platinum	ST 110 105 1809-06 0010
	Platinum	ST 110 105 1809-08 0010
	Durabronze (23kt Gold)	ST 110 105 1809-09 0010
	Dark Chrome	ST 110 105 1809-19 0010
	Brushed Durabronze (23kt Gold)	ST 110 105 1809-28 0010
	Matte Black	ST 110 105 1809-33 0010
	Brushed Bronze	ST 110 105 1809-42 0010
	Champagne (22kt Gold)	ST 110 105 1809-47 0010
	Brushed Chrome	ST 110 105 1809-93 0010
	Brushed Dark Platinum	ST 110 105 1809-99 0010

Individual components of this set

The following components are needed for this set



1x27 718 809-46



1x33 810 809-46 0010



## VAIA Single-lever mixer with side spray set - Brushed Champagne (22kt Gold)

---

ST 110 105 1809

## VAIA Single-lever mixer with side spray set - Brushed Champagne (22kt Gold)

ST 110 105 1809



- With round flange
- Spray mode
- Integrated diverter
- Total height 6-3/4"
- Side spray hole diameter 1-1/4"
- Fabric braided spray hose 59"
- Sprayface with descaling system
- lead-free
- This product can help a building meet the requirements of Green Building Rating Systems, e.g. LEED®, BREEAM®, DGNB

(ADA)

Can only be combined with 33810809, 33826809, 19815809, 19825809.

Internal backflow preventer.

Residual water may drip from the sprayer after shut-off

Flexible positioning of components.

Button has to be pressed while using.

	Brushed Champagne (22kt Gold)	27 718 809-46
	Chrome	27 718 809-00
	Brushed Platinum	27 718 809-06
	Platinum	27 718 809-08
	Durabronze (23kt Gold)	27 718 809-09
	Dark Chrome	27 718 809-19
	Brushed Durabronze (23kt Gold)	27 718 809-28
	Matte Black	27 718 809-33
	Brushed Bronze	27 718 809-42
	Champagne (22kt Gold)	27 718 809-47
	Brushed Chrome	27 718 809-93
	Brushed Dark Platinum	27 718 809-99

# VAIA Single-lever mixer with side spray set - Brushed Champagne (22kt Gold)

ST 110 105 1809

mm [inches]

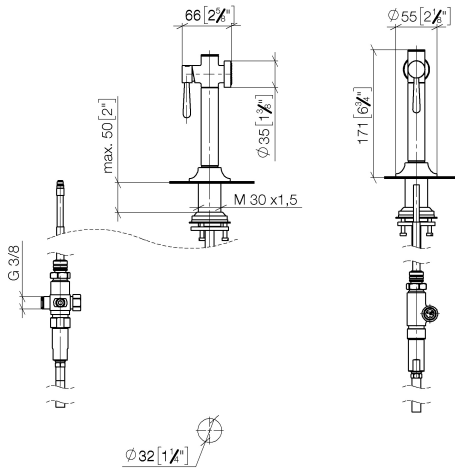

## Flow rate chart

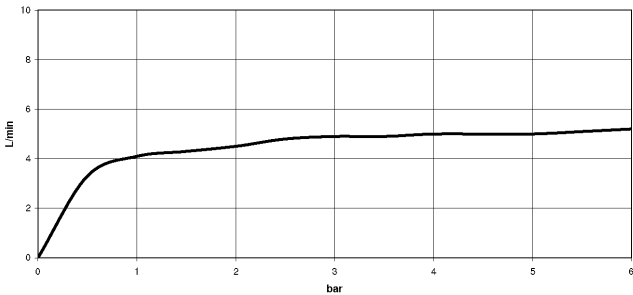

## Codes & Standards

DIN 4109

ISO 3822

NSF372

NSF61

## Ü-Zeichen

## Certificates

LGA\_38

IAPMO\_N-4976

IAPMO\_6397



## VAIA Single-lever mixer with side spray set - Brushed Champagne (22kt Gold)

---

ST 110 105 1809

# VAIA Single-lever mixer with side spray set - Brushed Champagne (22kt Gold)

ST 110 105 1809

Parts for other  
finishes can be found  
here: [Chrome](#)

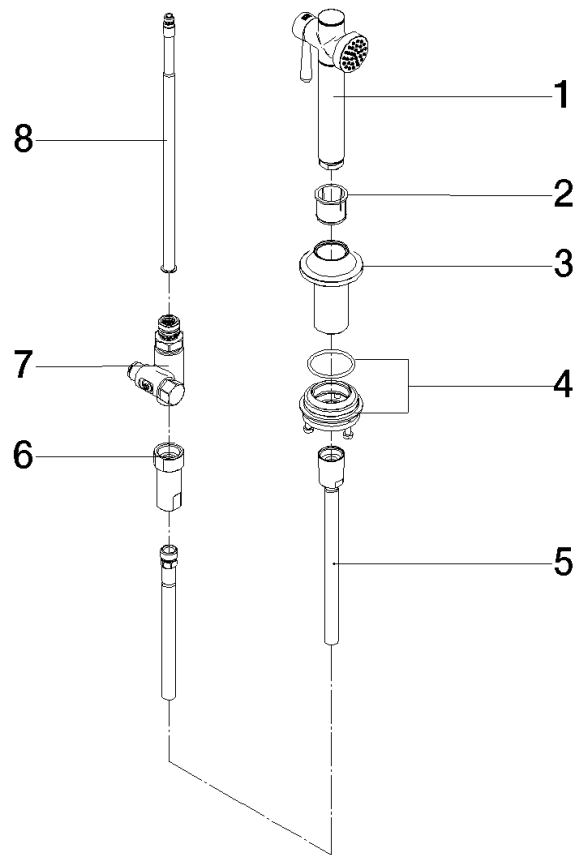

## Spare parts list

Number	Item Number	Designation	Number of units	Lead time
1	90 12 11 096 12-46	shower	1	30
2	90 18 40 085 00 90	sleeve	1	2
3	90 30 01 142 00-46	shaft	1	-
Spare part can no longer be ordered, please order the replacement item				
4	04 23 10 047 00 92	fixing set	1	60
5	90 30 02 062 00-46	hose	1	-
Spare part can no longer be ordered, please order the replacement item				
6	90 24 03 241 00 90	nipple	1	2
7	90 17 09 046 12 90	diverter	1	2
8	90 28 20 068 00 90	connection	1	2

# VAIA Single-lever mixer with side spray set - Brushed Champagne (22kt Gold)











ST 110 105 1809

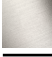

- 8" Projection
- Swiveling spout 360°
- Aerated stream
- Water flow rate limited to max. 1.5 gpm
- lead-free
- This product can help a building meet the requirements of Green Building Rating Systems, e.g. LEED®, BREEAM®, DGNB

(ADA)

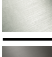
Single-lever mixer for use with rinsers and professional sprayers

	Brushed Champagne (22kt Gold)	33 810 809-46 0010
	Chrome	33 810 809-00 0010
	Brushed Platinum	33 810 809-06 0010
	Platinum	33 810 809-08 0010
	Durabrand (23kt Gold)	33 810 809-09 0010
	Dark Chrome	33 810 809-19 0010
	Brushed Durabrand (23kt Gold)	33 810 809-28 0010
	Matte Black	33 810 809-33 0010
	Champagne (22kt Gold)	33 810 809-47 0010
	Brushed Chrome	33 810 809-93 0010
	Brushed Dark Platinum	33 810 809-99 0010

## Recommended article



**VAIA Soap dispenser with flange - Brushed Champagne (22kt Gold)** 82 434 809-46

## Recommended article



**VAIA Side spray set - Brushed Champagne (22kt Gold)** 27 718 809-46

## Recommended article



**VAIA AIR SWITCH operating button, trim parts only - Brushed Champagne (22kt Gold)** 10 713 809-46



## VAIA Single-lever mixer with side spray set - Brushed Champagne (22kt Gold)

---

ST 110 105 1809





VAIA Single-lever mixer with side spray set - Brushed Champagne (22kt Gold)

ST 110 105 1809

Flow rate chart

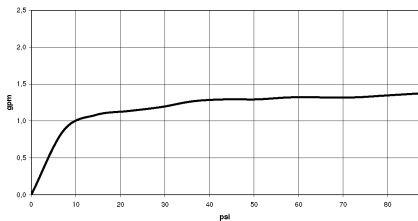

Codes & Standards

ASME A112.18.1	California Energy Commission (CEC)	cUPC	NSF372
NSF61			

Certificates

IAPMO\_N-4976      IAPMO\_6397      IAPMO\_4976 (



## VAIA Single-lever mixer with side spray set - Brushed Champagne (22kt Gold)

---

ST 110 105 1809

## VAIA Single-lever mixer with side spray set - Brushed Champagne (22kt Gold)

ST 110 105 1809

Parts for other  
finishes can be found  
here: [Chrome](#)

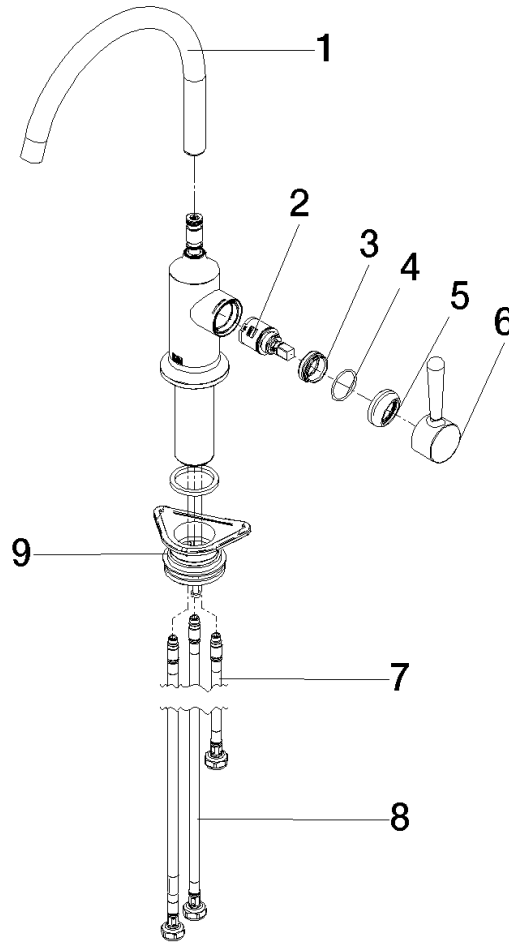

### Spare parts list

Number	Item Number	Designation	Number of units	Lead time
1	90 28 22 313 00-46	spout	1	30
2	90 15 05 042 00 90	cartridge	1	2
3	09 24 04 266 90	nut	1	2
4	09 14 10 091 90	seal	1	2
5	90 28 30 052 00-46	cover	1	30
6	90 20 80 050 00-46	handle	1	-
Spare part can no longer be ordered, please order the replacement item				
7	04 30 04 100 00 90	hose	1	2
8	04 30 04 103 00 90	hose	2	2
9	04 23 10 044 08 90	fixing set	1	2