



# TARA Three-hole mixer with Profi spray set - Chrome

ST 110 202 2892



- 9-1/4" Projection
- Swiveling spout 360°
- Aerated stream and spray mode
- Integrated diverter
- Sprayface with descaling system
- Water flow rate limited to max. 1.5 gpm
- lead-free
- This product can help a building meet the requirements of Green Building Rating Systems, e.g. LEED®, BREEAM®, DGNB

	Chrome	ST 110 202 2892-00 0010
	Brushed Platinum	ST 110 202 2892-06 0010
	Platinum	ST 110 202 2892-08 0010
	Dark Chrome	ST 110 202 2892-19 0010
	Brushed Bronze	ST 110 202 2892-42 0010
	Brushed Chrome	ST 110 202 2892-93 0010
	Brushed Dark Platinum	ST 110 202 2892-99 0010

## Individual components of this set

The following components are needed for this set



1x 27 799 970-00



1x 20 816 892-00 0010



## TARA Three-hole mixer with Profi spray set - Chrome

---

ST 110 202 2892

# TARA Three-hole mixer with Profi spray set - Chrome

ST 110 202 2892



- Spray mode
- Automatic diverter
- Total height 26-1/8"
- Flange diameter 2-1/8"
- Profi spray hole diameter 1-1/8"
- Sprayface with descaling system
- Profispray arm can be pivoted or locked into place
- lead-free







Can only be combined with 32815682, 33826861, 32815861, 33836888, 32816888, 20816892, 33836875, 32815875.

Internal backflow preventer.

Flexible positioning of components.

Button has to be pressed while using.

Profi spray set can be installed with or without flange

	Chrome	27 799 970-00
	Brushed Platinum	27 799 970-06
	Platinum	27 799 970-08
	Dark Chrome	27 799 970-19
	Brushed Bronze	27 799 970-42
	Brushed Chrome	27 799 970-93
	Brushed Dark Platinum	27 799 970-99

# TARA Three-hole mixer with Profi spray set - Chrome

ST 110 202 2892

mm [inches]  
1:10

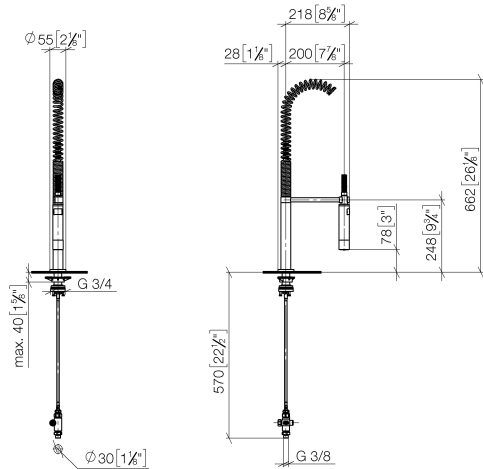

## Flow rate chart

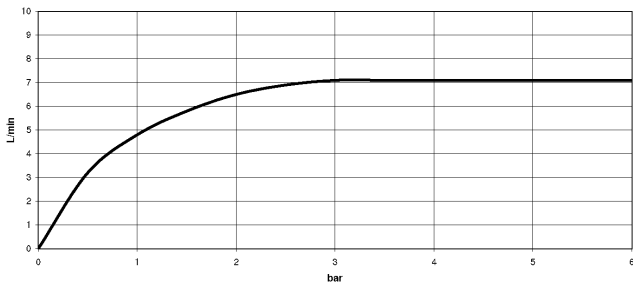

## Codes & Standards

DIN 4109	EN 1717	ISO 3822	NSF372
NSF61	Ü-Zeichen		

## Certificates

IAPMO_6397	LGA_38	Belgaqua_24-005-2	IAPMO_N-4976
------------	--------	-------------------	--------------

## TARA Three-hole mixer with Profi spray set - Chrome

---

ST 110 202 2892

## TARA Three-hole mixer with Profi spray set - Chrome

ST 110 202 2892

Parts for other  
finishes can be found  
here: Brushed  
Platinum

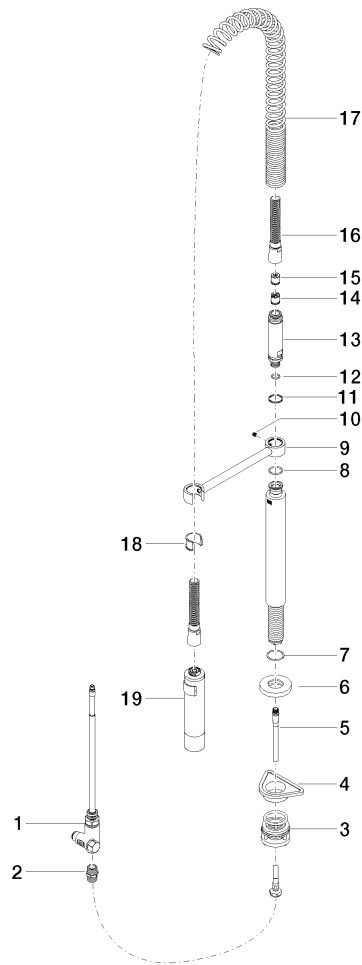

### Spare parts list

Number	Item Number	Designation	Number of units	Lead time
1	90 17 09 046 12 90	diverter	1	2
2	90 24 03 250 00 90	nipple	1	2
3	04 23 10 004 03 90	fixing set	1	2
4	09 18 40 090 90	sleeve	1	2
5	04 30 04 104 00 90	hose	1	2
6	90 27 86 000 00-00	rosette	1	10
7	09 14 10 120 90	seal	1	2
8	09 14 10 031 90	seal	1	2
9	04 17 20 014 00-00	holder	1	10
10	09 31 11 049 90	pin	1	2
11	09 14 15 012 90	ring	1	2
12	09 14 10 003 90	seal	1	2
13	09 30 01 067 10-00	adaptor	1	10
14	90 23 01 141 00 90	back-flow preventer	1	2
15	09 23 01 046 90	back-flow preventer	1	2
16	90 30 02 065 00-00	hose	1	10
17	09 16 02 034 90	spring	1	2
18	90 18 40 035 00 90	sleeve	1	2
19	04 12 11 094 10-00	shower	1	10

# TARA Three-hole mixer with Profi spray set - Chrome

ST 110 202 2892



- 9-1/4" Projection
- Swiveling spout 360°
- Aerated stream
- Total height 14-5/8"
- Height to aerator/spout outlet 8-3/8"
- Spout hole diameter 1-3/8"
- Valve hole diameter 1-1/4"
- Water flow rate limited to max. 1.5 gpm
- lead-free
- This product can help a building meet the requirements of Green Building Rating Systems, e.g. LEED®, BREEAM®, DGNB (ADA)

	Chrome	20 816 892-00 0010
	Brushed Platinum	20 816 892-06 0010
	Platinum	20 816 892-08 0010
	Durabrand (23kt Gold)	20 816 892-09 0010
	Dark Chrome	20 816 892-19 0010
	Brushed Durabrand (23kt Gold)	20 816 892-28 0010
	Matte Black	20 816 892-33 0010
	Brushed Bronze	20 816 892-42 0010
	Brushed Champagne (22kt Gold)	20 816 892-46 0010
	Champagne (22kt Gold)	20 816 892-47 0010
	Brushed Chrome	20 816 892-93 0010
	Brushed Dark Platinum	20 816 892-99 0010

## Recommended article

**AIR SWITCH operating button, trim parts only - Chrome** 10 713 970-00



## TARA Three-hole mixer with Profi spray set - Chrome

---

ST 110 202 2892



## TARA Three-hole mixer with Profi spray set - Chrome

ST 110 202 2892

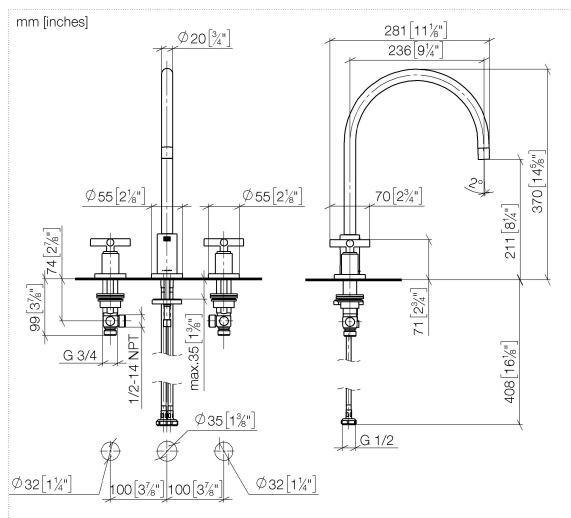

### Flow rate chart

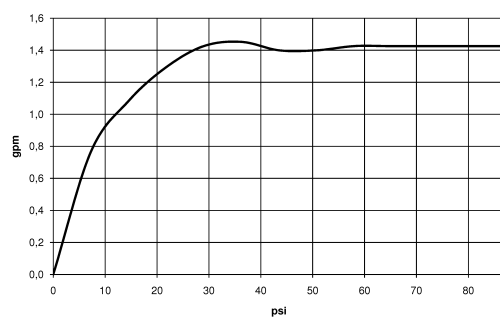

# TARA Three-hole mixer with Profi spray set - Chrome

ST 110 202 2892

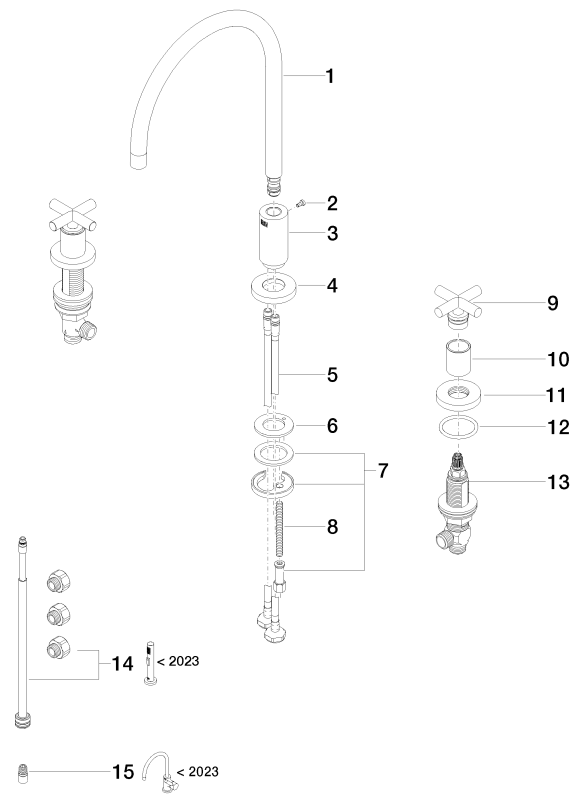

## Spare parts list

Number	Item Number	Designation	Number of units	Lead time
1	90 28 22 226 02-00	spout	1	10
2	09 30 30 057 90	screw	1	2
3	09 11 10 036-00	connection	1	10
4	09 28 10 140-00	ring	1	10
5	04 30 04 019 00 90	hose	2	2
6	09 14 05 047 90	seal	1	2
7	04 30 11 038 00 90	fixing set	1	2
8	09 31 11 011 90	pin	1	2
9	90 20 89 010 10-00	handle	2	10
10	09 21 02 140-00	sleeve	2	10
11	09 27 89 105-00	rosette	2	10
12	90 14 10 043 00 90	seal	2	2
13	90 17 11 040 51 90	side panel	2	2
14	90 17 09 046 13 90	conversion kit	1	2
15	90 24 03 537 01 90	adaptor	1	2