

# VAIA Two-hole bridge mixer with side spray set - Chrome

ST 110 202 4809



- 9-1/2" Projection
- Swiveling spout 360°
- Aerated stream and spray mode
- Integrated diverter
- Total height 13-7/8"
- Height to aerator/spout outlet 9-1/2"
- Side spray hole diameter 1-1/4"
- 2 x pressure hose with 3/8" compression fitting
- Fabric braided spray hose 59"
- Sprayface with descaling system
- Water flow rate limited to max. 1.5 gpm
- lead-free
- This product can help a building meet the requirements of Green Building Rating Systems, e.g. LEED®, BREEAM®, DGNB

|  |                                |                         |
|--|--------------------------------|-------------------------|
|  | Chrome                         | ST 110 202 4809-00 0010 |
|  | Brushed Platinum               | ST 110 202 4809-06 0010 |
|  | Platinum                       | ST 110 202 4809-08 0010 |
|  | Durabronze (23kt Gold)         | ST 110 202 4809-09 0010 |
|  | Dark Chrome                    | ST 110 202 4809-19 0010 |
|  | Brushed Durabronze (23kt Gold) | ST 110 202 4809-28 0010 |
|  | Matte Black                    | ST 110 202 4809-33 0010 |
|  | Brushed Bronze                 | ST 110 202 4809-42 0010 |
|  | Brushed Champagne (22kt Gold)  | ST 110 202 4809-46 0010 |
|  | Champagne (22kt Gold)          | ST 110 202 4809-47 0010 |
|  | Brushed Chrome                 | ST 110 202 4809-93 0010 |
|  | Brushed Dark Platinum          | ST 110 202 4809-99 0010 |

## Individual components of this set

The following components are needed for this set



1x 27 718 809-00



1x 19 825 809-00 0010



## VAIA Two-hole bridge mixer with side spray set - Chrome

---

ST 110 202 4809

## VAIA Two-hole bridge mixer with side spray set - Chrome

ST 110 202 4809



- With round flange
- Spray mode
- Integrated diverter
- Total height 6-3/4"
- Side spray hole diameter 1-1/4"
- Fabric braided spray hose 59"
- Sprayface with descaling system
- lead-free
- This product can help a building meet the requirements of Green Building Rating Systems, e.g. LEED®, BREEAM®, DGNB

(ADA)

Can only be combined with 33810809, 33826809, 19815809, 19825809.

Internal backflow preventer.

Residual water may drip from the sprayer after shut-off

Flexible positioning of components.

Button has to be pressed while using.

|  |                               |               |
|--|-------------------------------|---------------|
|  | Chrome                        | 27 718 809-00 |
|  | Brushed Platinum              | 27 718 809-06 |
|  | Platinum                      | 27 718 809-08 |
|  | Durabrand (23kt Gold)         | 27 718 809-09 |
|  | Dark Chrome                   | 27 718 809-19 |
|  | Brushed Durabrand (23kt Gold) | 27 718 809-28 |
|  | Matte Black                   | 27 718 809-33 |
|  | Brushed Bronze                | 27 718 809-42 |
|  | Brushed Champagne (22kt Gold) | 27 718 809-46 |
|  | Champagne (22kt Gold)         | 27 718 809-47 |
|  | Brushed Chrome                | 27 718 809-93 |
|  | Brushed Dark Platinum         | 27 718 809-99 |

VAIA Two-hole bridge mixer with side spray set - Chrome

ST 110 202 4809

mm [inches]

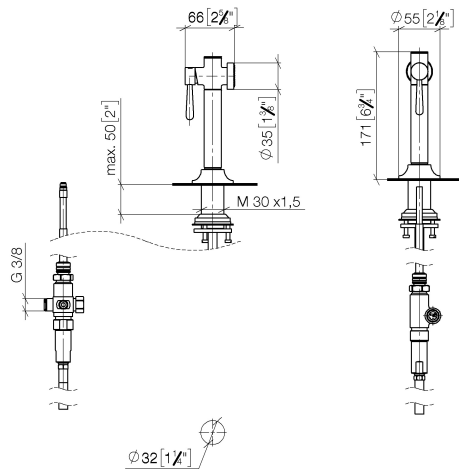

Flow rate chart

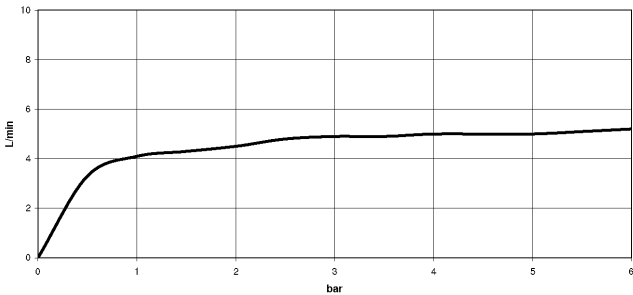

Codes & Standards

|          |          |        |       |
|----------|----------|--------|-------|
| DIN 4109 | ISO 3822 | NSF372 | NSF61 |
|----------|----------|--------|-------|

Ü-Zeichen

Certificates

|        |              |            |
|--------|--------------|------------|
| LGA_38 | IAPMO_N-4976 | IAPMO_6397 |
|--------|--------------|------------|



## VAIA Two-hole bridge mixer with side spray set - Chrome

---

ST 110 202 4809

# VAIA Two-hole bridge mixer with side spray set - Chrome

ST 110 202 4809

Parts for other  
finishes can be found  
here: Brushed  
Platinum

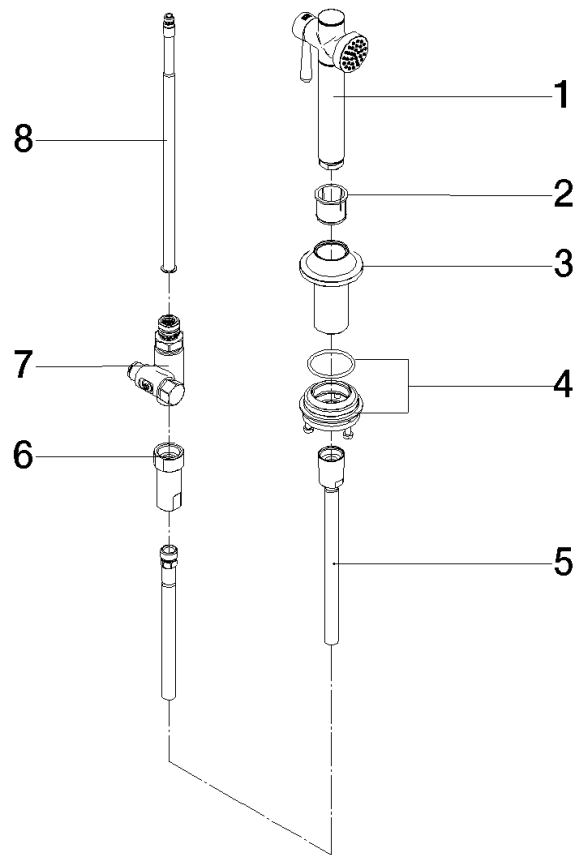

## Spare parts list

| Number | Item Number        | Designation | Number of units | Lead time |
|--------|--------------------|-------------|-----------------|-----------|
| 1      | 90 12 11 096 12-00 | shower      | 1               | 10        |
| 2      | 90 18 40 085 00 90 | sleeve      | 1               | 2         |
| 3      | 90 30 01 142 00-00 | shaft       | 1               | 10        |
| 4      | 04 23 10 047 00 92 | fixing set  | 1               | 60        |
| 5      | 90 30 02 062 00-00 | hose        | 1               | 10        |
| 6      | 90 24 03 241 00 90 | nipple      | 1               | 2         |
| 7      | 90 17 09 046 12 90 | diverter    | 1               | 2         |
| 8      | 90 28 20 068 00 90 | connection  | 1               | 2         |











VAIA Two-hole bridge mixer with side spray set - Chrome

ST 110 202 4809



- 9-1/2" Projection
- Swiveling spout 360°
- Aerated stream
- Water flow rate limited to max. 1.5 gpm
- lead-free
- This product can help a building meet the requirements of Green Building Rating Systems, e.g. LEED®, BREEAM®, DGNB

Two-hole mixer for use with rinsers and professional sprayers

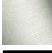
|  |                               |                    |
|--|-------------------------------|--------------------|
|  | Chrome                        | 19 825 809-00 0010 |
|  | Brushed Platinum              | 19 825 809-06 0010 |
|  | Platinum                      | 19 825 809-08 0010 |
|  | Durabrand (23kt Gold)         | 19 825 809-09 0010 |
|  | Dark Chrome                   | 19 825 809-19 0010 |
|  | Brushed Durabrand (23kt Gold) | 19 825 809-28 0010 |
|  | Matte Black                   | 19 825 809-33 0010 |
|  | Brushed Champagne (22kt Gold) | 19 825 809-46 0010 |
|  | Champagne (22kt Gold)         | 19 825 809-47 0010 |
|  | Brushed Chrome                | 19 825 809-93 0010 |
|  | Brushed Dark Platinum         | 19 825 809-99 0010 |

Recommended article



**VAIA Soap dispenser with flange - Chrome** 82 434 809-00

Recommended article



**VAIA AIR SWITCH operating button, trim parts only - Chrome** 10 713 809-00



## VAIA Two-hole bridge mixer with side spray set - Chrome

---

ST 110 202 4809







## VAIA Two-hole bridge mixer with side spray set - Chrome

---

ST 110 202 4809

# VAIA Two-hole bridge mixer with side spray set - Chrome

ST 110 202 4809

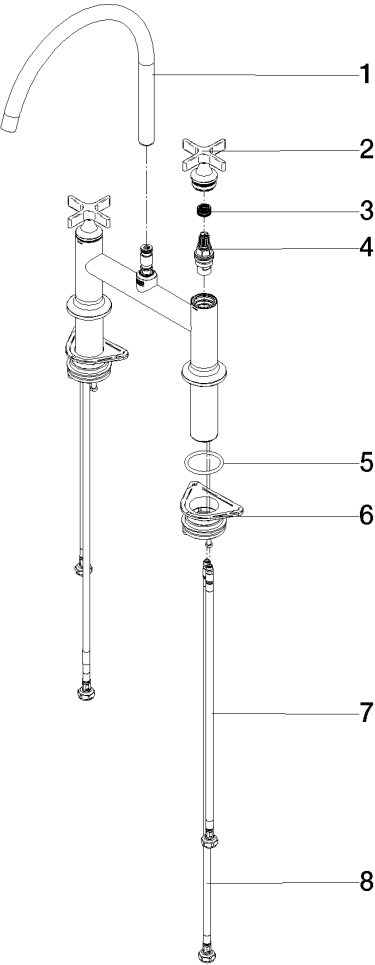

## Spare parts list

| Number | Item Number        | Designation | Number of units | Lead time |
|--------|--------------------|-------------|-----------------|-----------|
| 1      | 90 28 22 396 01-00 | spout       | 1               | 10        |
| 2      | 90 20 80 036 00-00 | handle      | 2               | 10        |
| 3      | 90 12 12 232 00 90 | fixing cap  | 2               | 2         |
| 4      | 90 90 03 131 00 90 | top         | 2               | 2         |
| 5      | 90 14 10 043 00 90 | seal        | 2               | 2         |
| 6      | 04 30 11 040 00 90 | fixing set  | 2               | 2         |
| 7      | 04 30 04 100 00 90 | hose        | 2               | 2         |
| 8      | 04 30 04 103 00 90 | hose        | 2               | 2         |