

META Tub spout for wall-mounted installation - Brushed Bronze

META

13 801 660 Product version from 5/28/2021



- 7-7/8" Projection
- Round aerator
- Flange diameter 2-3/8"
- 1-1/2" hole diameter
- 1/2" connection
- Water flow rate limited to max. 6.5 gpm

| | | |
|---|-------------------------------|---------------|
|  | Brushed Bronze | 13 801 660-42 |
|  | Chrome | 13 801 660-00 |
|  | Brushed Platinum | 13 801 660-06 |
|  | Dark Chrome | 13 801 660-19 |
|  | Light gold | 13 801 660-26 |
|  | Brushed Light Gold | 13 801 660-27 |
|  | Matte Black | 13 801 660-33 |
|  | Brushed Champagne (22kt Gold) | 13 801 660-46 |
|  | Champagne (22kt Gold) | 13 801 660-47 |
|  | Brushed Chrome | 13 801 660-93 |
|  | Brushed Dark Platinum | 13 801 660-99 |

Recommended article

Rough-in adapter -

35 080 970-90
0010



mm [inches]

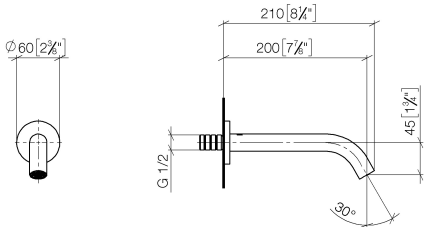

Flow rate chart

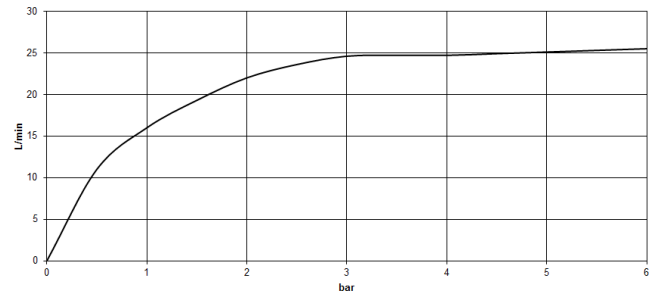

Codes & Standards

| | | | |
|----------------|------|------------------------|-----------------------------|
| ASME A112.18.1 | cUPC | Scottish Water Byelaws | UK Water Supply Regulations |
|----------------|------|------------------------|-----------------------------|



META Tub spout for wall-mounted installation - Brushed Bronze

META

13 801 660 Product version from 5/28/2021

Certificates and sustainability

IAPMO_4976

WRAS_250402

