

## MEM Tub spout for wall-mounted installation - Brushed Dark Brass

MEM

13 801 782 Product version from 3/10/2014



- 8-5/8" Projection
- Rectangular aerated stream
- Flange 2-3/8" x 2-3/8"
- 1-1/2" hole diameter
- 1/2" connection
- Water flow rate limited to max. 10.2 gpm

	Brushed Dark Brass	13 801 782-39
	Chrome	13 801 782-00
	Brushed Platinum	13 801 782-06
	Platinum	13 801 782-08
	Dark Chrome	13 801 782-19
	Brushed Durabronze (23kt Gold)	13 801 782-28
	Brushed Champagne (22kt Gold)	13 801 782-46
	Champagne (22kt Gold)	13 801 782-47
	Brushed Dark Platinum	13 801 782-99

13 801 782 Product version from 3/10/2014

mm [inches]



**Flow rate chart**



## MEM Tub spout for wall-mounted installation - Brushed Dark Brass

MEM

13 801 782 Product version from 3/10/2014

Parts for other  
finishes can be found  
here: [Chrome](#)

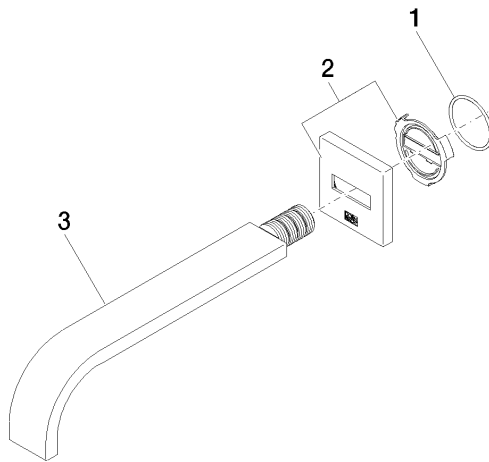

### Spare parts list

Number	Item Number	Designation	Number of units	Lead time
3	04 28 22 290 00-39	spout	1.00	-
Spare part can no longer be ordered, please order the replacement item				
2	90 27 78 035 00-39	rosette	1.00	30
1	09 14 10 111 90	seal	1.00	2