



VAIA Two-hole bridge mixer For sprayer / professional sprayer - Brushed Champagne (22kt Gold)

VAIA

19 815 809    Product version from 7/1/2023



- 9-1/2" Projection
  - Swiveling spout 360°
  - Aerated stream
  - Water flow rate limited to max. 1.5 gpm
  - lead-free
  - This product can help a building meet the requirements of Green Building Rating Systems, e.g. LEED®, BREEAM®, DGNB
- Two-hole mixer for use with rinsers and professional sprayers

	Brushed Champagne (22kt Gold)	19 815 809-46 0010
	Chrome	19 815 809-00 0010
	Brushed Platinum	19 815 809-06 0010
	Platinum	19 815 809-08 0010
	Durabrass (23kt Gold)	19 815 809-09 0010
	Dark Chrome	19 815 809-19 0010
	Brushed Durabrass (23kt Gold)	19 815 809-28 0010
	Matte Black	19 815 809-33 0010
	Brushed Bronze	19 815 809-42 0010
	Champagne (22kt Gold)	19 815 809-47 0010
	Brushed Chrome	19 815 809-93 0010
	Brushed Dark Platinum	19 815 809-99 0010

Recommended article

**VAIA Soap dispenser with flange -** 82 434 809-46  
**Brushed Champagne (22kt Gold)**



Recommended article

**VAIA AIR SWITCH operating** 10 713 809-46  
**button, trim parts only - Brushed**  
**Champagne (22kt Gold)**



VAIA Two-hole bridge mixer For sprayer / professional sprayer - Brushed Champagne (22kt Gold)

VAIA

19 815 809 Product version from 7/1/2023  
mm [inches]

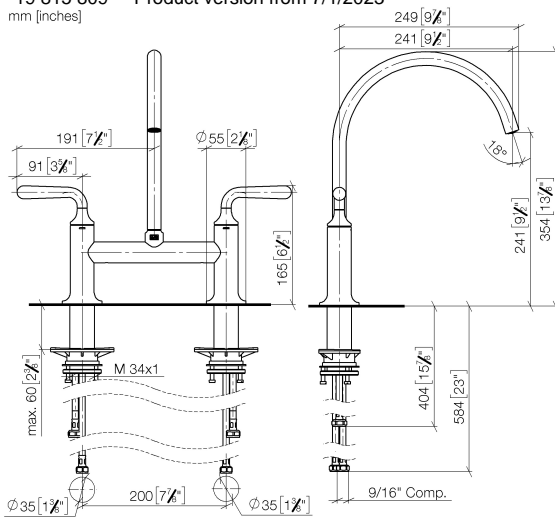

## Codes & Standards

ASME A112.18.1	California Energy Commission (CEC)	cUPC	NSF372
NSF61			

## Certificates and sustainability

IAPMO\_4976      IAPMO\_N-4976      IAPMO\_6397

## VAIA Two-hole bridge mixer For sprayer / professional sprayer - Brushed Champagne (22kt Gold)

VAIA

19 815 809 Product version from 7/1/2023

Parts for other  
finishes can be found  
here: [Chrome](#)

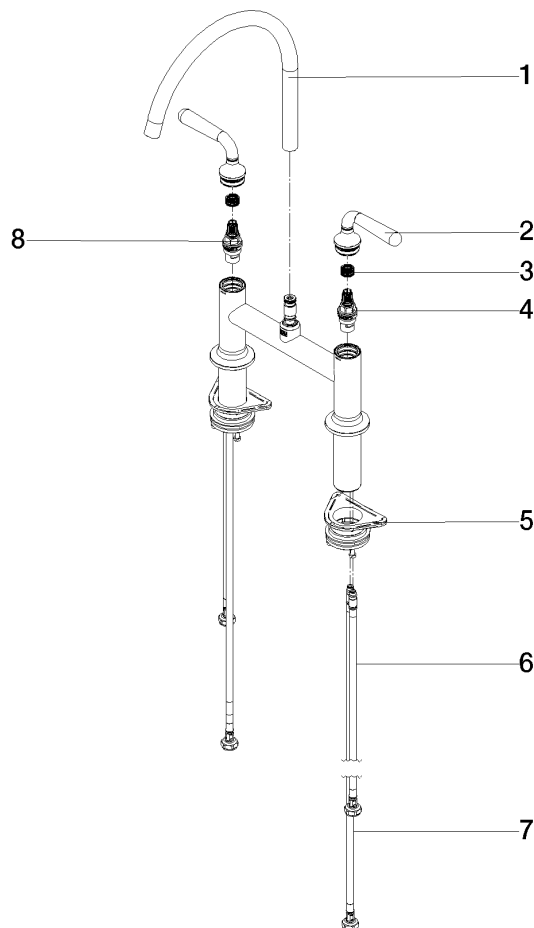

### Spare parts list

Number	Item Number	Designation	Number of units	Lead time
2	90 20 80 057 00-46	handle	2.00	30
4	90 90 03 130 00 90	top	1.00	2
7	04 30 04 103 00 90	hose	2.00	2
6	04 30 04 100 00 90	hose	2.00	2
5	04 30 11 040 00 90	fixing set	2.00	2
3	90 12 12 232 00 90	fixing cap	2.00	2
1	90 28 22 396 01-46	spout	1.00	30
8	90 90 03 131 00 90	top	1.00	2