

VAIA Two-hole bridge mixer For sprayer / professional sprayer - Brushed Dark Platinum

VAIA

19 825 809 Product version from 7/1/2023



- 9-1/2" Projection
- Swiveling spout 360°
- Aerated stream
- Water flow rate limited to max. 1.5 gpm
- lead-free
- This product can help a building meet the requirements of Green Building Rating Systems, e.g. LEED®, BREEAM®, DGNB

Two-hole mixer for use with rinsers and professional sprayers

	Brushed Dark Platinum	19 825 809-99 0010
	Chrome	19 825 809-00 0010
	Brushed Platinum	19 825 809-06 0010
	Platinum	19 825 809-08 0010
	Durabrass (23kt Gold)	19 825 809-09 0010
	Dark Chrome	19 825 809-19 0010
	Brushed Durabrass (23kt Gold)	19 825 809-28 0010
	Matte Black	19 825 809-33 0010
	Brushed Bronze	19 825 809-42 0010
	Brushed Champagne (22kt Gold)	19 825 809-46 0010
	Champagne (22kt Gold)	19 825 809-47 0010
	Brushed Chrome	19 825 809-93 0010

Recommended article

VAIA AIR SWITCH operating button, trim parts only - Brushed Dark Platinum

10 713 809-99



Recommended article

VAIA Soap dispenser with flange - Brushed Dark Platinum

82 434 809-99





VAIA Two-hole bridge mixer For sprayer / professional sprayer - Brushed Dark Platinum

VAIA

19 825 809 Product version from 7/1/2023
mm [inches]

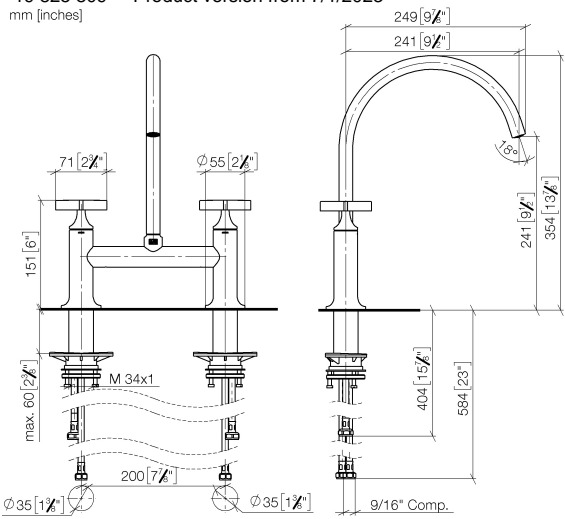

Codes & Standards

ASME A112.18.1	California Energy Commission (CEC)	cUPC	NSF372
NSF61			

Certificates and sustainability

IAPMO_4976	IAPMO_N-4976	IAPMO_6397
------------	--------------	------------

VAIA Two-hole bridge mixer For sprayer / professional sprayer - Brushed Dark Platinum

VAIA

19 825 809 Product version from 7/1/2023

Parts for other
finishes can be found
here: [Chrome](#)

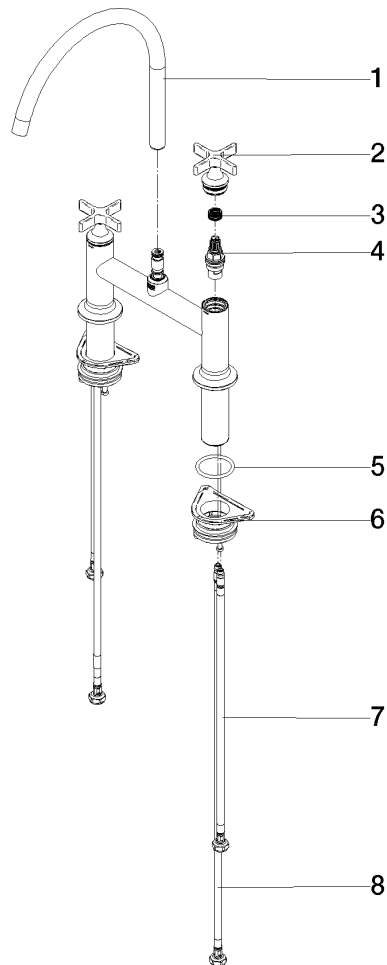

Spare parts list

Number	Item Number	Designation	Number of units	Lead time
4	90 90 03 131 00 90	top	2.00	2
3	90 12 12 232 00 90	fixing cap	2.00	2
2	90 20 80 036 00-99	handle	2.00	20
1	90 28 22 396 01-99	spout	1.00	20
7	04 30 04 100 00 90	hose	2.00	2
8	04 30 04 103 00 90	hose	2.00	2
6	04 30 11 040 00 90	fixing set	2.00	2
5	90 14 10 043 00 90	seal	2.00	2