



## MEM Deck valve counter-clockwise closing hot - Champagne (22kt Gold)

20 000 783 Product version from 3/10/2014

- 1-1/4" hole diameter
- Flange 2-3/8" x 2-3/8"
- with marking for hot

(ADA)



	Champagne (22kt Gold)	20 000 783-47
	Chrome	20 000 783-00
	Brushed Platinum	20 000 783-06
	Platinum	20 000 783-08
	Dark Chrome	20 000 783-19
	Brushed Durabronze (23kt Gold)	20 000 783-28
	Brushed Champagne (22kt Gold)	20 000 783-46
	Brushed Dark Platinum	20 000 783-99

**MEM Deck valve counter-clockwise closing hot - Champagne (22kt Gold)**

20 000 783 Product version from 3/10/2014

mm [inches]

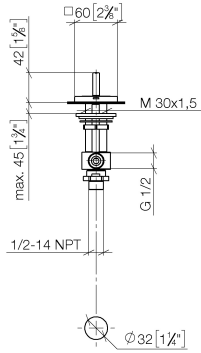

**Flow rate chart**



**Codes & Standards**

ADA

ASME  
A112.18.1/CSA  
B125.1

Scottish Water  
Byelaws

UK Water Supply  
Regulations



## MEM Deck valve counter-clockwise closing hot - Champagne (22kt Gold)

---

20 000 783 Product version from 3/10/2014

### Certificates

---

WRAS\_2103

**MEM Deck valve counter-clockwise closing hot - Champagne (22kt Gold)**

20 000 783 Product version from 3/10/2014

Parts for other finishes can be found here: [Chrome](#)

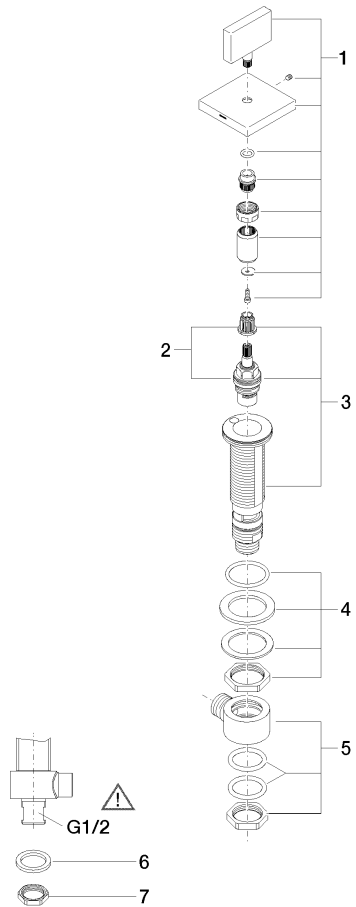

**Spare parts list**

Number	Item Number	Designation	Number of units	Lead time
1	90 20 78 002 05-47	handle ( hot )	1	30
2	90 90 03 132 00 90	top	1	2
3	04 17 11 058 32 90	side panel	1	2
4	04 23 10 032 78 90	fixing set	1	2
5	04 17 11 023 10 90	distributor	1	2
6	09 30 11 059 90	disc	1	2
7	09 23 10 012 90	nut	1	2