

VAIA Three-hole lavatory mixer with drain - Champagne (22kt Gold)

VAIA





20 713 809 Product version from 5/27/2021



- 6-5/8" Projection
- US drain with overflow
- Swiveling spout 360°
- Round aerated stream
- Total height 11"
- Height to aerator/spout outlet 7-1/2"
- Valve hole diameter 1-1/4"
- Spout hole diameter 1-3/8"
- Flange diameter 2-3/8"
- Water flow rate limited to max. 1.2 gpm
- lead-free
- This product can help a building meet the requirements of Green Building Rating Systems, e.g. LEED®, BREEAM®, DGNB

(ADA)

Suitable only for basins with overflow.

	Champagne (22kt Gold)	20 713 809-47 0010
	Chrome	20 713 809-00 0010
	Brushed Platinum	20 713 809-06 0010
	Platinum	20 713 809-08 0010
	Dark Chrome	20 713 809-19 0010
	Brushed Durabronze (23kt Gold)	20 713 809-28 0010
	Brushed Bronze	20 713 809-42 0010
	Brushed Champagne (22kt Gold)	20 713 809-46 0010
	Brushed Dark Platinum	20 713 809-99 0010

20 713 809 Product version from 5/27/2021

mm [inches]

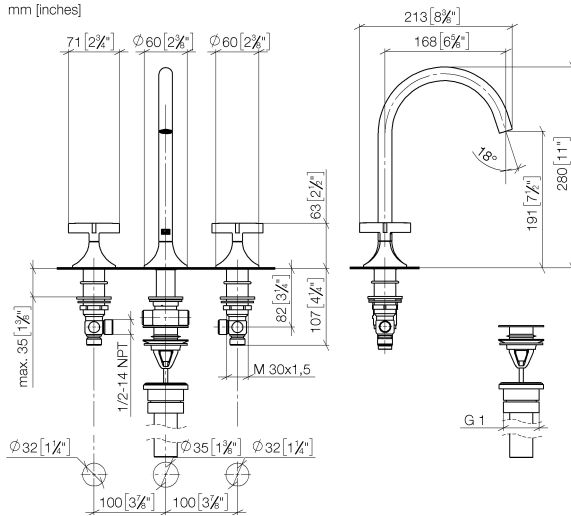

Codes & Standards

ADA

California Energy
Commission
(CEC)

EPA WaterSense

NSF372

NSF61

WaterSense



Certificates and sustainability

IAPMO_N-4

IAPMO_8834

IAPMO_6

Parts for other
finishes can be found
here: [Chrome](#)

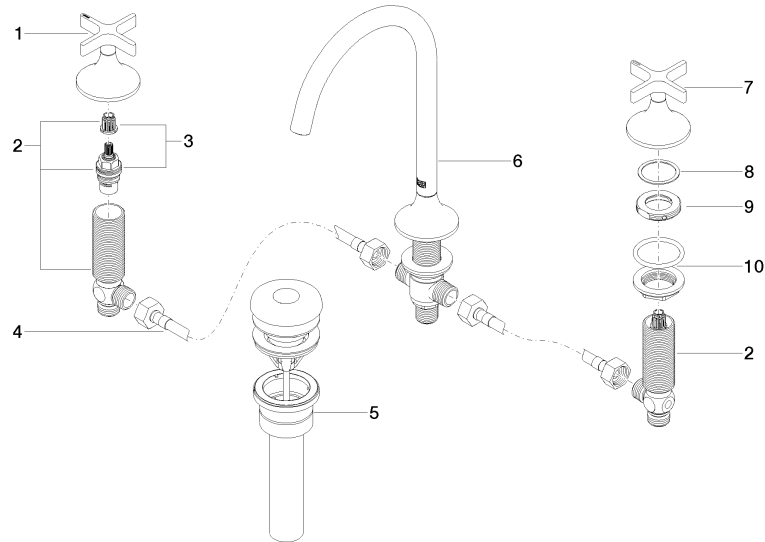

Spare parts list

Number	Item Number	Designation	Number of units	Lead time
	2 04 17 11 055 51 90	side panel	2.00	2
	8 09 28 10 003 90	ring	2.00	2
	6 13 716 809-47 0010	VAIA Lavatory spout, deck-mounted without drain - Champagne (22kt Gold)	1.00	-
Spare part can no longer be ordered, please order the replacement item				
	9 09 24 01 028 90	ring	2.00	2
	5 10 125 970-47 0010	Umbrella drain 1 1/4" - Champagne (22kt Gold)	1.00	30
	10 04 23 10 032 46 90	fixing set	2.00	2
	1 90 20 80 011 00-47	handle (hot)	1.00	30
	3 90 90 03 151 00 90	top	2.00	2
	4 04 30 04 096 00 90	hose	2.00	2
	7 90 20 80 010 00-47	handle (cold)	1.00	30