



VAIA Single-hole lavatory mixer with drain - Brushed Durabrass (23kt Gold)







VAIA

22 513 809 Product version from 4/1/2025



- 6-5/8" Projection
- US drain with overflow
- Swiveling spout 360°
- Round aerated stream
- Total height 12-1/8"
- Height to aerator/spout outlet 8-3/4"
- 1-3/8" hole diameter
- Flange diameter 2-3/8"
- 2x 3/8" flexible supply lines
- 2x 3/8" US flexible supply lines
- Water flow rate limited to max. 1.2 gpm
- lead-free
- This product can help a building meet the requirements of Green Building Rating Systems, e.g. LEED®, BREEAM®, DGNB

Suitable only for basins with overflow.  
(ADA)

	Brushed Durabrass (23kt Gold)	22 513 809-28 0010
	Chrome	22 513 809-00 0010
	Brushed Platinum	22 513 809-06 0010
	Platinum	22 513 809-08 0010
	Dark Chrome	22 513 809-19 0010
	Brushed Dark Brass	22 513 809-39 0010
	Brushed Bronze	22 513 809-42 0010
	Brushed Champagne (22kt Gold)	22 513 809-46 0010
	Champagne (22kt Gold)	22 513 809-47 0010
	Brushed Dark Platinum	22 513 809-99 0010



VAIA Single-hole lavatory mixer with drain - Brushed Durabross (23kt Gold)

VAIA

22 513 809 Product version from 4/1/2025

mm [inches]

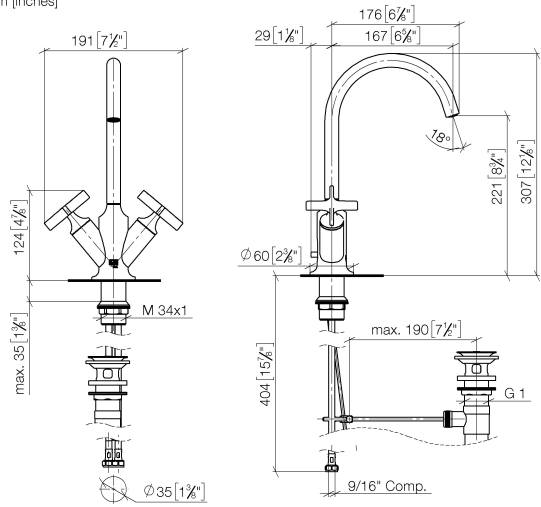

Codes & Standards

ADA

California Energy  
Commission  
(CEC)

NSF372

NSF61

Certificates and sustainability

IAPMO\_6397

IAPMO\_N-4976

22 513 809 Product version from 4/1/2025

Parts for other  
finishes can be found  
here: [Chrome](#)

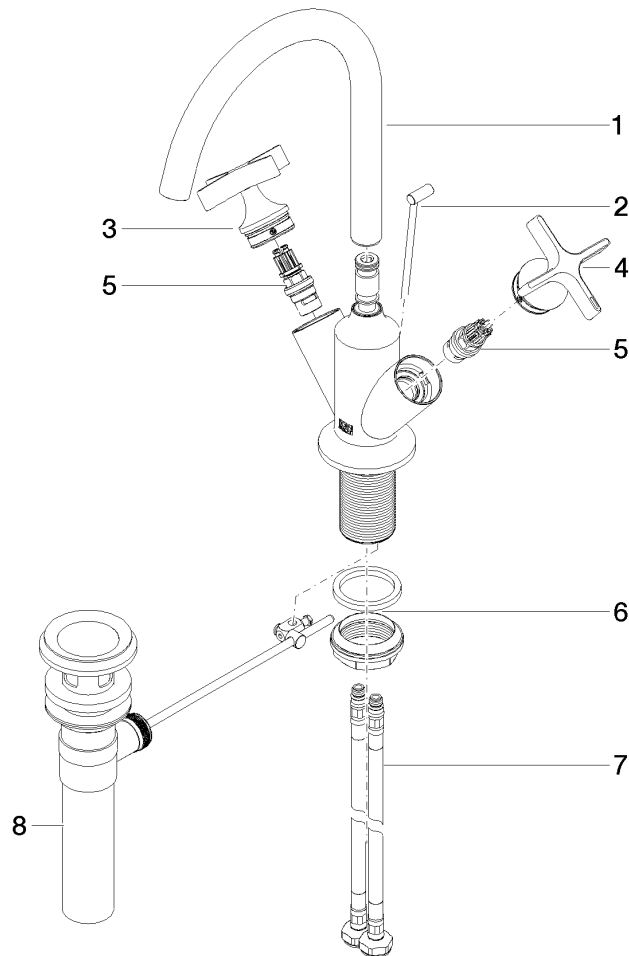

## Spare parts list

Number	Item Number	Designation	Number of units	Lead time
1	90 28 22 320 01-28	spout	1.00	20
3	90 20 66 029 01-28	handle ( hot )	1.00	20
5	90 90 03 175 00 90	top	2.00	2
4	90 20 66 028 00-28	handle ( cold )	1.00	20
7	04 30 04 102 00 90	Flexible supply line 3/8" -	2.00	2
2	04 20 89 035 80-28	pull-rod	1.00	20
6	04 23 10 044 07 90	fixing set	1.00	2
8	90 11 01 023 00-28	pop-up waste	1.00	20