

IMO Single-hole lavatory mixer with stand pipe without drain - Chrome







IMO

22 585 671 Product version from 4/1/2024



- 7-5/8" Projection
  - Rigid spout
  - Rectangular aerated stream
  - Total height 40-7/8" - 43-3/8"
  - Height to aerator/spout outlet 38-1/4" - 41"
  - Flange diameter 5-3/8"
  - Water flow rate limited to max. 1.2 gpm
  - lead-free
  - This product can help a building meet the requirements of Green Building Rating Systems, e.g. LEED®, BREEAM®, DGNB
- (ADA)**

(ADA)

	Chrome	22 585 671-00 0010
	Brushed Platinum	22 585 671-06 0010
	Dark Chrome	22 585 671-19 0010
	Matte Black	22 585 671-33 0010
	Brushed Chrome	22 585 671-93 0010
	Brushed Dark Platinum	22 585 671-99 0010

Required article



- Floor mounting rough set -** 35 949 970-90
- Min. rough in depth 3-1/8" 0010
  - Max. rough in depth 5-7/8"

**IMO Single-hole lavatory mixer with stand pipe without drain - Chrome**

IMO

22 585 671 Product version from 4/1/2024

mm [inches]

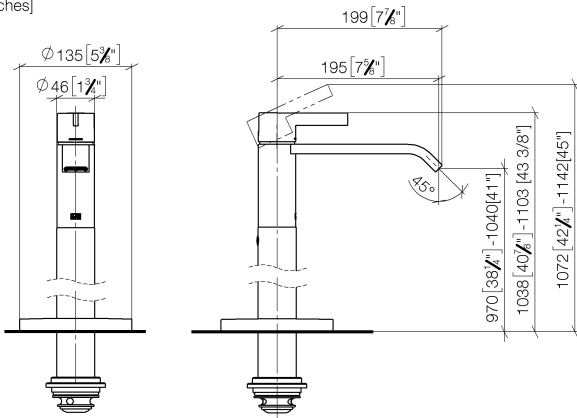

**Codes & Standards**

ADA ASME A112.18.1 cUPC EPA WaterSense

NSF372 NSF61 WaterSense



**Certificates and sustainability**

IAPMO\_N-4976 IAPMO\_6397 IAPMO\_8834 IAPMO\_4976 (

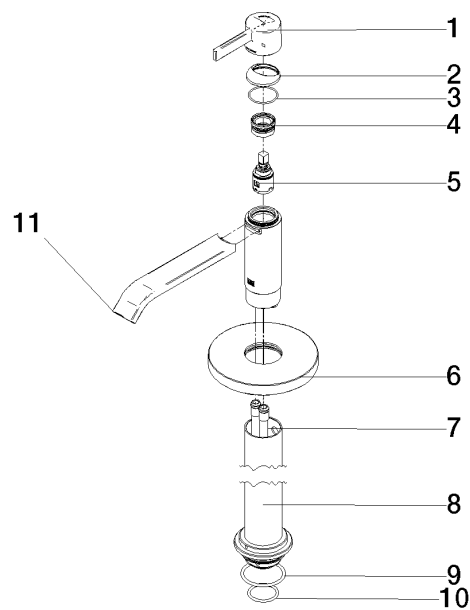

## Spare parts list

Number	Item Number	Designation	Number of units	Lead time
10	09 14 10 018 90	seal	1.00	2
3	09 14 10 102 90	seal	1.00	2
9	09 14 10 084 90	seal	1.00	2
7	04 28 22 022 10 90	connection	2.00	2
1	90 20 67 019 00-00	handle	1.00	10
2	90 28 30 059 00-00	cover	1.00	10
4	90 23 10 146 00 90	nut	1.00	2
8	90 28 22 574 00-00	pipe	1.00	10
11	90 28 22 407 00-00	spout	1.00	10
6	09 27 88 005-00	rosette	1.00	60
5	90 15 05 042 00 90	cartridge	1.00	2