

VAIA Slide bar set without hand shower - Chrome

VAIA

26 413 809 Product version from 4/1/2025



- Shower hose connection 3/8"
- Metal shower hose 66-7/8" with anti-twist device
- Slide bar

Technical data:

- Center to center 31-1/2"
- Flange diameter 2-3/8"
- Pipe diameter 3/4"

Notes:

This article does not include a hand shower!

NOTE: Hand shower sold separately. Please see hand shower options under the miscellaneous articles section of each series.

	Chrome	26 413 809-00
	Brushed Platinum	26 413 809-06
	Platinum	26 413 809-08
	Dark Chrome	26 413 809-19
	Brushed Durabronze (23kt Gold)	26 413 809-28
	Brushed Dark Brass	26 413 809-39
	Brushed Bronze	26 413 809-42
	Brushed brass (PVD)	26 413 809-43
	Brushed Champagne (22kt Gold)	26 413 809-46
	Champagne (22kt Gold)	26 413 809-47
	Brushed Dark Platinum	26 413 809-99

Recommended article

	Rough-in adapter -	35 080 970-90
	• Please order rough-in adapter 35 080 970-90 0010 if installed with wall elbow.	0010

Recommended article

	VAIA Wall elbow - Chrome	28 450 809-00
---	---------------------------------	---------------

Required article

	Hand shower FlowReduce - Chrome	28 016 979-00
		0010

Required article

	Hand shower FlowReduce - Chrome	28 018 979-00
		0010

Required article

	SERIES-VARIOUS Hand shower FlowReduce - Chrome	28 027 979-00
		0010

Recommended article

	Rough-in adapter -	35 080 970-90
		0010

Required article

	Hand shower FlowReduce - Chrome	28 012 979-00
		0010

Recommended article

	VAIA Wall elbow - Chrome	28 450 809-00
---	---------------------------------	---------------

Required article

	SERIES-VARIOUS Hand shower FlowReduce - Chrome	28 025 979-00
		0010

VAIA Slide bar set without hand shower - Chrome

VAIA

26 413 809 Product version from 4/1/2025

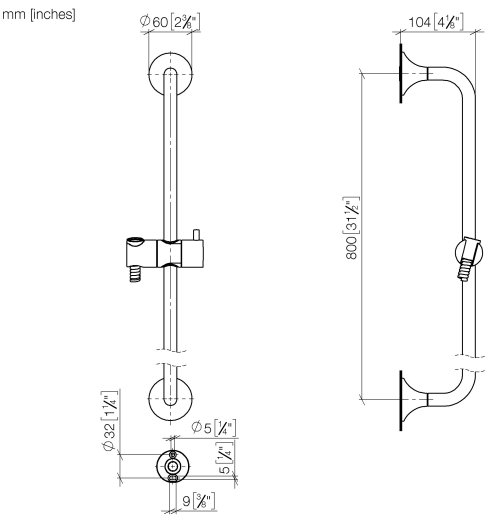

Codes & Standards

ASME A112.18.1	cUPC	Scottish Water Byelaws	UK Water Supply Regulations
XP P 41-280			

Certificates and sustainability

WRAS_2009	ACS_20 ACC LY	IAPMO_4976
-----------	---------------	------------

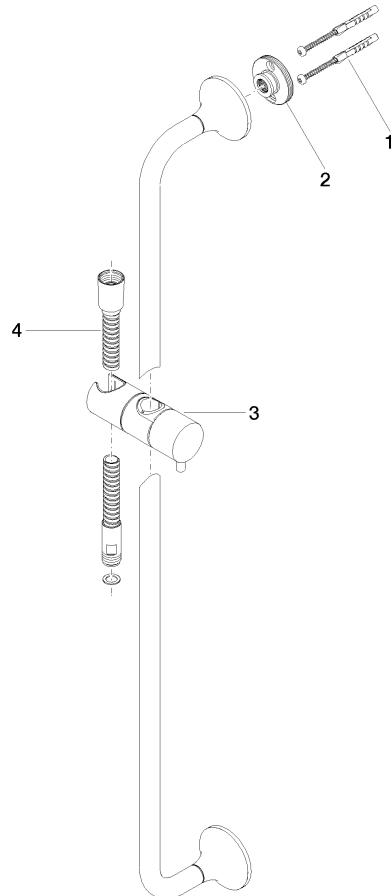

Spare parts list

Number	Item Number	Designation	Number of units	Lead time
3	12 580 970-00	Slider - Chrome	1.00	50
1	05 30 31 025 00 90	fixing set	2.00	2
2	90 17 20 759 00 90	disc	2.00	2
4	28 322 970-00	Metal shower hose 1/2" x 3/8" x 68-7/8" - Chrome	1.00	2