

Slide bar set without hand shower - Chrome

SERIES SPECIFIC

26 413 980 Product version from 6/1/2024



- Slide bar
- Pipe diameter 3/4"
- Flange 2-3/8" x 2-3/8"
- Center to center 31-1/2"
- Metal shower hose 68-7/8" with anti-twist device
- Shower hose connection 3/8"

This article does not include a hand shower!

NOTE: Hand shower sold separately. Please see hand shower options under the miscellaneous articles section of each series.

This article does not include a hand shower!

NOTE: Hand shower sold separately. Please see hand shower options under the miscellaneous articles section of each series.

	Chrome	26 413 980-00
	Brushed Platinum	26 413 980-06
	Platinum	26 413 980-08
	Dark Chrome	26 413 980-19
	Brushed Light Gold	26 413 980-27
	Brushed Durabrass (23kt Gold)	26 413 980-28
	Matte Black	26 413 980-33
	Brushed Champagne (22kt Gold)	26 413 980-46
	Champagne (22kt Gold)	26 413 980-47
	Brushed Chrome	26 413 980-93
	Brushed Dark Platinum	26 413 980-99

Required article

	Rough-in adapter -	35 080 970-00
	•Please order rough-in adapter 35 080 970-00 0010 if installed with wall elbow.	0010

Required article

	Hand shower FlowReduce - Chrome	28 012 979-00 0010
---	--	--------------------

Required article

	Hand shower FlowReduce - Chrome	28 018 979-00 0010
---	--	--------------------

Required article

	SERIES-VARIOUS Hand shower FlowReduce - Chrome	28 029 979-00 0010
---	---	--------------------

Required article

	Hand shower FlowReduce - Chrome	28 016 979-00 0010
---	--	--------------------

Recommended article

	Wall elbow - Chrome	28 450 980-00
---	----------------------------	---------------

Required article

	SERIES-VARIOUS Hand shower FlowReduce - Chrome	28 025 979-00 0010
---	---	--------------------

Required article

	SERIES-VARIOUS Hand shower FlowReduce - Chrome	28 027 979-00 0010
---	---	--------------------

Slide bar set without hand shower - Chrome

SERIES SPECIFIC

26 413 980 Product version from 6/1/2024

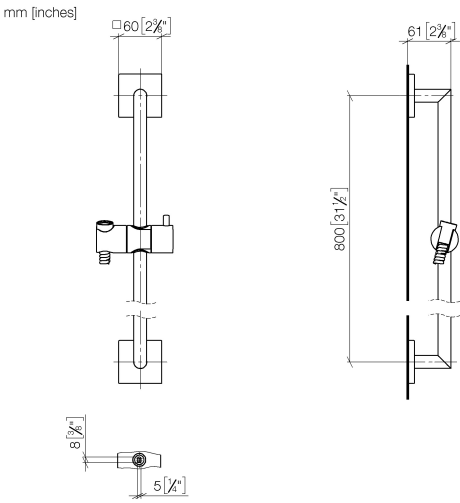

Codes & Standards

ASME A112.18.1	cUPC	Scottish Water Byelaws	UK Water Supply Regulations
XP P 41-280			

Certificates and sustainability

WRAS_2009	ACS_20 ACC LY	IAPMO_4976
-----------	---------------	------------

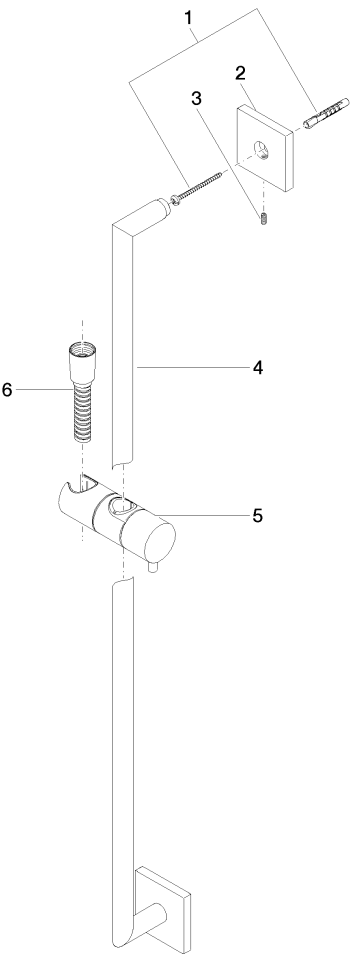

Spare parts list

Number	Item Number	Designation	Number of units	Lead time
6	28 322 970-00	Metal shower hose 1/2" x 3/8" x 68-7/8" - Chrome	1.00	2
1	05 30 31 025 00 90	fixing set	2.00	2
4	05 28 22 590 01-00	bar	1.00	10
3	09 31 11 061 90	pin	2.00	2
5	12 580 970-00	Slider - Chrome	1.00	10
2	08 17 98 507-00	holder	2.00	10