

LISSÉ Hand shower set with individual flanges FlowReduce - Dark Chrome

LISSÉ





27 802 845

Product version from 4/1/2024

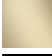

- COMPACT RAIN, flow rate max. 1.8 gpm (at 3 bar)
- Descaling system
- 3/8" Shower outlet
- Flange for wall elbow 2-3/8" x 3-1/8"
- Wall bracket with flange 2-3/8" x 3-1/8"
- Metal shower hose 49-1/4" with anti-twist device
- 1/2" wall elbow
- This product reduces water consumption by 28% (compared to requirements of EPAct '92)
- This product contributes to meeting the requirements of the LEED® Green Building Rating
- This product can help a building meet the requirements of Green Building Rating Systems, e.g. LEED®, BREEAM®, DGNB

Internal backflow preventer.

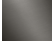
	Dark Chrome	27 802 845-19 0010
	Chrome	27 802 845-00 0010
	Brushed Platinum	27 802 845-06 0010
	Brushed Light Gold	27 802 845-27 0010
	Matte Black	27 802 845-33 0010
	Brushed Chrome	27 802 845-93 0010
	Brushed Dark Platinum	27 802 845-99 0010

mm [inches]

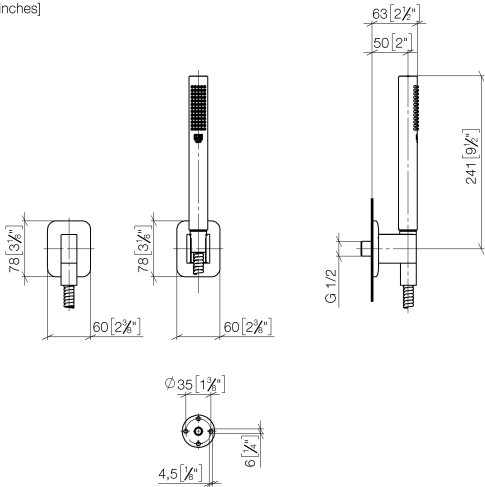

Codes & Standards

ASME A112.18.1	California Energy Commission (CEC)	cUPC	DIN 4109
ISO 3822	Ü-Zeichen		

Certificates and sustainability

LGA_29	IAPMO_4976		
--------	------------	--	--

Parts for other finishes can be found here: [Chrome](#)

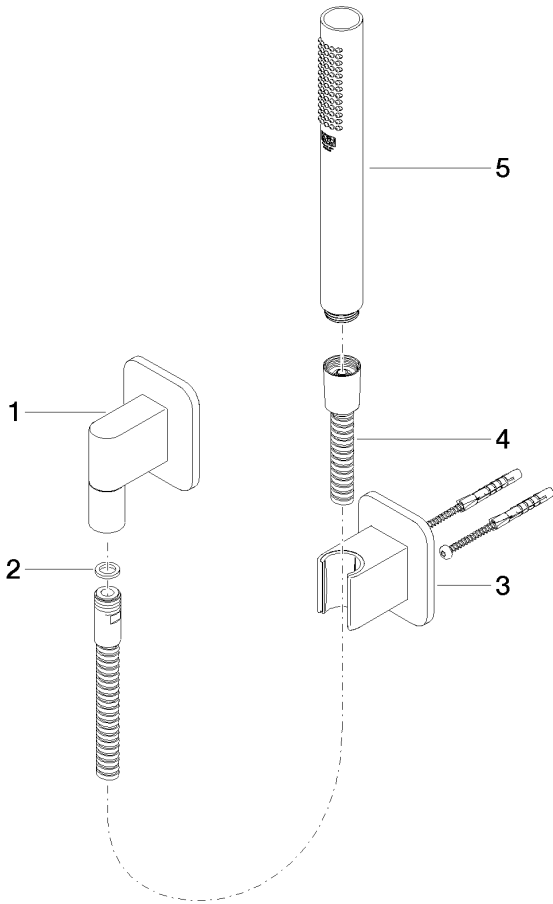

Spare parts list

Number	Item Number	Designation	Number of units	Lead time
4	90 30 02 072 00-19	Metal shower hose 1/2" x 3/8" x 49-1/4" - Dark Chrome	1.00	20
2	90 14 20 026 00 90	seal	1.00	2
3	28 050 845-19	LISSÉ Wall bracket - Dark Chrome	1.00	20
1	28 450 845-19	LISSÉ Wall elbow - Dark Chrome	1.00	20
5	90 12 11 140 41-19	shower	1.00	20