









LISSE Hand shower set with individual flanges FlowReduce - Brushed Light Gold

LISSE

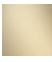
27 802 845 Product version from 4/1/2024

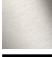

- COMPACT RAIN, flow rate max. 1.8 gpm (at 3 bar)
 - Descaling system
 - 3/8" Shower outlet
 - Flange for wall elbow 2-3/8" x 3-1/8"
 - Wall bracket with flange 2-3/8" x 3-1/8"
 - Metal shower hose 49-1/4" with anti-twist device
 - 1/2" wall elbow
 - This product reduces water consumption by 28% (compared to requirements of EPAct '92)
 - This product contributes to meeting the requirements of the LEED® Green Building Rating
 - This product can help a building meet the requirements of Green Building Rating Systems, e.g. LEED®, BREEAM®, DGNB
- Internal backflow preventer.**
- Internal backflow preventer.

	Brushed Light Gold	27 802 845-27 0010
	Chrome	27 802 845-00 0010
	Brushed Platinum	27 802 845-06 0010
	Dark Chrome	27 802 845-19 0010
	Matte Black	27 802 845-33 0010
	Brushed Chrome	27 802 845-93 0010
	Brushed Dark Platinum	27 802 845-99 0010

Required article

Rough-in adapter - 35 080 970-90 0010





LISSE Hand shower set with individual flanges FlowReduce - Brushed Light Gold

LISSE

27 802 845 Product version from 4/1/2024
mm [inches]

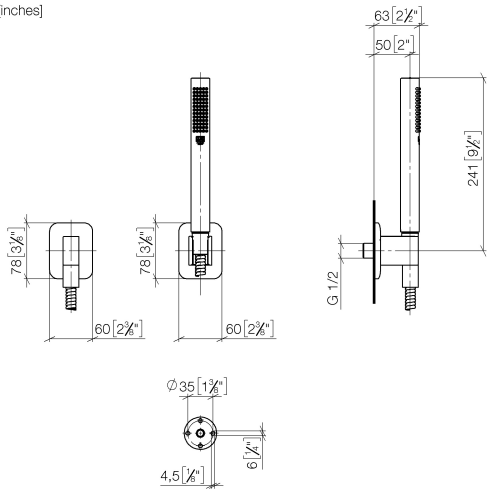

Codes & Standards

California Energy Commission (CEC)	DIN 4109	ISO 3822	Ü-Zeichen
------------------------------------	----------	----------	-----------

Certificates and sustainability

LGA_29

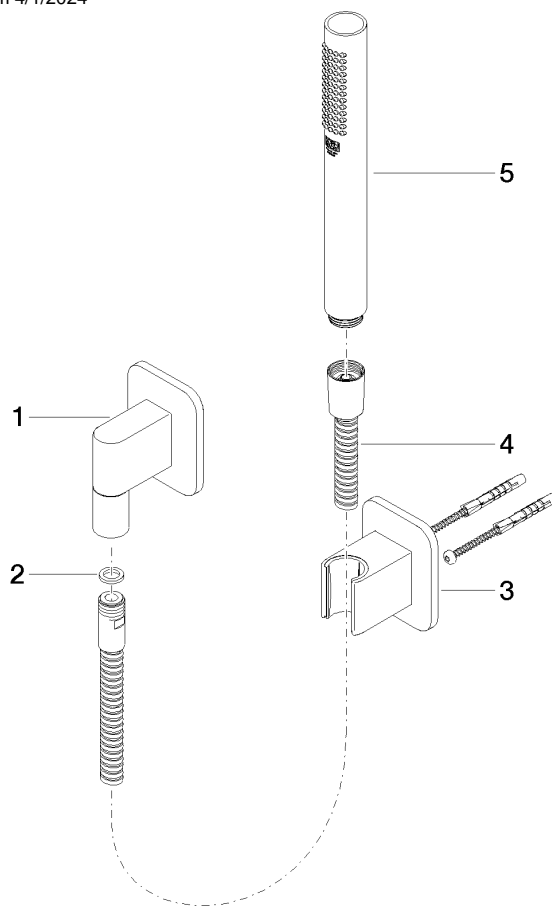

Spare parts list

Number	Item Number	Designation	Number of units	Lead time
2	90 14 20 026 00 90	seal	1.00	2
4	90 30 02 072 00-27	Metal shower hose 1/2" x 3/8" x 49-1/4" - Brushed Light Gold	1.00	30
5	90 12 11 140 41-27	shower	1.00	30
3	28 050 845-27	LISSE Wall bracket - Brushed Light Gold	1.00	30
1	28 450 845-27	LISSE Wall elbow - Brushed Light Gold	1.00	30