

## Hand shower set with integrated wall bracket FlowReduce - Brushed Dark Brass

SERIES SPECIFIC

27 803 660 Product version from 8/1/2018



- COMPACT RAIN, flow rate max. 1.8 gpm (at 3 bar)
- 3 individual sprays (standard, soft, massage) + 2 combinations (standard+soft, soft+massage)
- Descaling system
- 3/8" Shower outlet
- Metal shower hose 49-1/4" with anti-twist device
- Flange diameter 2-3/8"
- 1/2" connection
- Function from: 1.6 gpm
- This product reduces water consumption by 28% (compared to requirements of EPA '92)
- This product contributes to meeting the requirements of the LEED® Green Building Rating
- This product can help a building meet the requirements of Green Building Rating Systems, e.g. LEED®, BREEAM®, DGNB

Internal backflow preventer.

	Brushed Dark Brass	27 803 660-39 0010
	Chrome	27 803 660-00 0010
	Brushed Platinum	27 803 660-06 0010
	Platinum	27 803 660-08 0010
	Dark Chrome	27 803 660-19 0010
	Light gold	27 803 660-26 0010
	Brushed Light Gold	27 803 660-27 0010
	Brushed Durabrass (23kt Gold)	27 803 660-28 0010
	Matte Black	27 803 660-33 0010
	Brushed Bronze	27 803 660-42 0010
	Brushed Champagne (22kt Gold)	27 803 660-46 0010
	Champagne (22kt Gold)	27 803 660-47 0010
	Brushed Chrome	27 803 660-93 0010
	Brushed Dark Platinum	27 803 660-99 0010

Hand shower set with integrated wall bracket FlowReduce - Brushed Dark Brass

SERIES SPECIFIC

27 803 660

Product version from 8/1/2018

mm [inches]

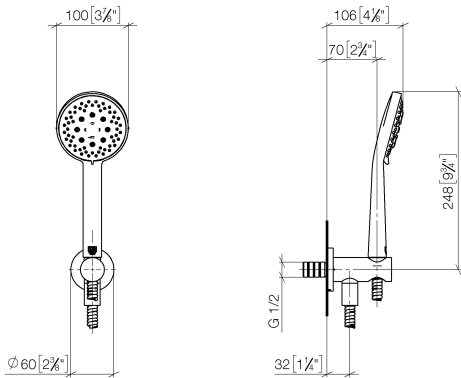

Codes & Standards

California Energy Commission (CEC)	DIN 4109	ISO 3822	Ü-Zeichen
------------------------------------	----------	----------	-----------

Certificates and sustainability

LGA\_29

## Hand shower set with integrated wall bracket FlowReduce - Brushed Dark Brass

SERIES SPECIFIC

27 803 660 Product version from 8/1/2018

Parts for other  
finishes can be found  
here: [Chrome](#)

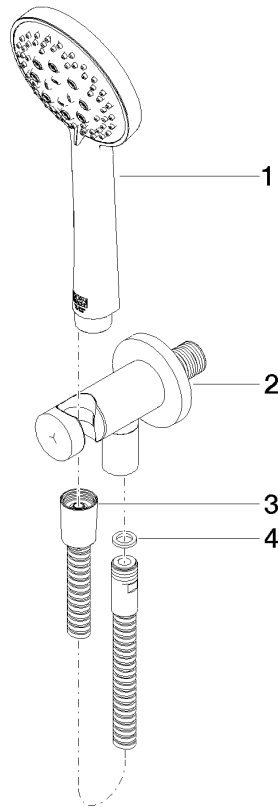

### Spare parts list

Number	Item Number	Designation	Number of units	Lead time
2	28 490 660-39	Wall elbow with integrated wall bracket - Brushed Dark Brass	1.00	30
3	90 30 02 072 00-39	hose	1.00	30
1	28 014 979-39 0010	shower	1.00	-
Spare part can no longer be ordered, please order the replacement item				
4	90 14 20 026 00 90	seal	1.00	2