





- 3 individual sprays (standard, soft, massage) + 2 combinations (standard+soft, soft+massage)
- Descaling system
- 1/2" Shower outlet
- Wall elbow with flange Ø 2-1/8"
- Wall bracket with flange Ø 2-1/8"
- Metal shower hose 49-1/4" with anti-twist device
- 1/2" wall elbow
- Water flow rate limited to max. 1.8 gpm

	Chrome	27 803 832-00 0010
	Soft Black	27 803 832-69 0010

27 803 832 Product version from 1/1/2023

mm [inches]

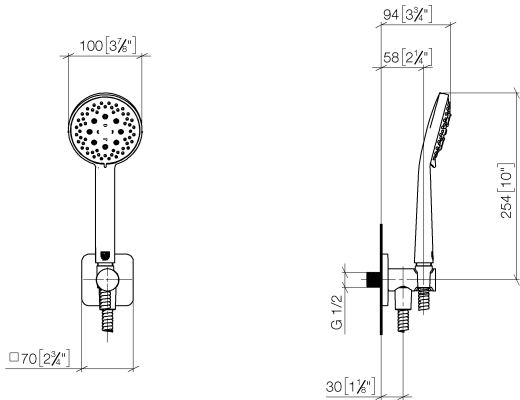

Codes & Standards

ASME A112.18.1 California Energy Commission (CEC) cUPC EPA WaterSense

WaterSense



Certificates and sustainability

IAPMO_11777 IAPMO_4976

Parts for other
finishes can be found
here: [Soft Black](#)

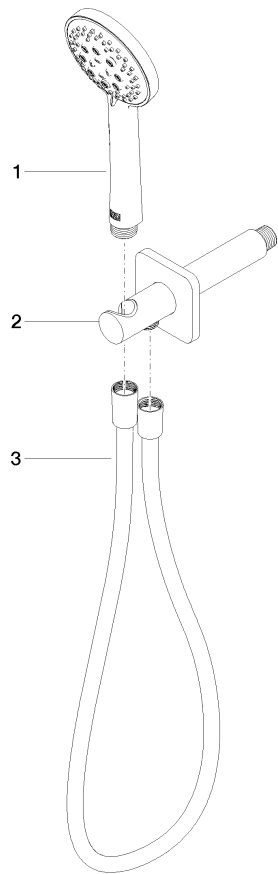

Spare parts list

Number	Item Number	Designation	Number of units	Lead time
2	90 27 83 019 01-00	connection	1.00	2
3	90 30 03 010 00-00	hose	1.00	2
1	90 12 11 143 30-00	shower	1.00	2