

TARA Hand shower set with individual flanges FlowReduce - Chrome

TARA

27 803 892 Product version from 6/30/2015 to 7/11/2018



- 3-way or 5-way adjustable: COMPACT RAIN, COMPACT SOFT FLOW, COMPACT AQUAPRESSURE FLOW, flow rate max. 1.8 gpm (at 3 bar)
- Descaling system
- Metal shower hose 49-1/4" with anti-twist device
- 1/2" Shower outlet

Technical data:

- Wall elbow with flange Ø 2-1/8"
- Wall bracket with flange Ø 2-1/8"
- 1/2" wall elbow

Internal backflow preventer.

Internal backflow preventer.

	Chrome	27 803 892-00 0010
	Brushed Platinum	27 803 892-06 0010
	Platinum	27 803 892-08 0010
	Dark Chrome	27 803 892-19 0010
	Brushed Durabrass (23kt Gold)	27 803 892-28 0010
	Matte Black	27 803 892-33 0010
	Brushed Dark Brass	27 803 892-39 0010
	Brushed Bronze	27 803 892-42 0010
	Brushed Champagne (22kt Gold)	27 803 892-46 0010
	Champagne (22kt Gold)	27 803 892-47 0010
	Brushed Chrome	27 803 892-93 0010
	Brushed Dark Platinum	27 803 892-99 0010

Required article

Rough-in adapter -

35 080 970-90
0010



TARA Hand shower set with individual flanges FlowReduce - Chrome

TARA

27 803 892 Product version from 6/30/2015 to 7/11/2018

mm [inches]

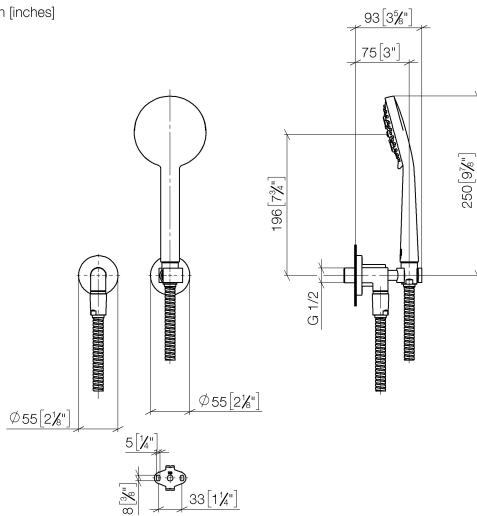

Codes & Standards

ASME A112.18.1	California Energy Commission (CEC)	cUPC	DIN 4109
ISO 3822	Ü-Zeichen		

Certificates and sustainability

LGA_29 IAPMO_4976

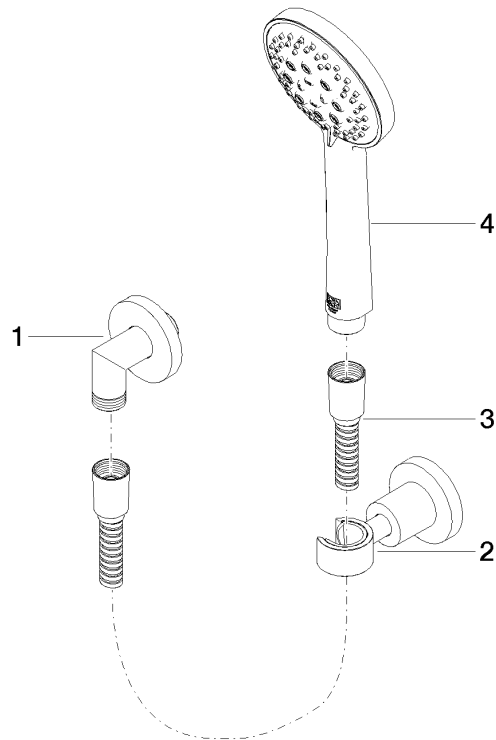

Spare parts list

Number	Item Number	Designation	Number of units	Lead time
2	28 050 892-00	TARA Wall bracket - Chrome	1.00	10
3	28 104 970-00	Metal shower hose 1/2" x 1/2" x 49-1/4" - Chrome	1.00	2
1	28 450 892-00	connection	1.00	60
4	28 014 979-00 0010	Hand shower - Chrome	1.00	-
Spare part can no longer be ordered, please order the replacement item				
	28018979-000010	Hand shower FlowReduce - Chrome		