



Metal shower hose 1/2" x 3/8" x 68-7/8" - Matte Black

SERIES-VARIOUS

28 322 970    Product version from 4/1/2024



|   |                               |               |
|---|-------------------------------|---------------|
|    | Matte Black                   | 28 322 970-33 |
|    | Chrome                        | 28 322 970-00 |
|    | Brushed Platinum              | 28 322 970-06 |
|    | Platinum                      | 28 322 970-08 |
|    | Durabrass (23kt Gold)         | 28 322 970-09 |
|   | Dark Brass matte              | 28 322 970-16 |
|    | Dark Chrome                   | 28 322 970-19 |
|    | Light gold                    | 28 322 970-26 |
|    | Brushed Light Gold            | 28 322 970-27 |
|   | Brushed Durabrass (23kt Gold) | 28 322 970-28 |
|  | Brushed Bronze                | 28 322 970-42 |
|  | Brushed Champagne (22kt Gold) | 28 322 970-46 |
|  | Champagne (22kt Gold)         | 28 322 970-47 |
|  | Brushed Chrome                | 28 322 970-93 |
|  | Brushed Dark Platinum         | 28 322 970-99 |



## Metal shower hose 1/2" x 3/8" x 68-7/8" - Matte Black

SERIES-VARIOUS

28 322 970 Product version from 4/1/2024



Metal shower hose 1/2" x 3/8" x 68-7/8" - Matte Black

SERIES-VARIOUS

28 322 970    Product version from 4/1/2024

Codes & Standards

|                           |                                |             |
|---------------------------|--------------------------------|-------------|
| Scottish Water<br>Byelaws | UK Water Supply<br>Regulations | XP P 41-280 |
|---------------------------|--------------------------------|-------------|

Certificates and sustainability

|           |               |
|-----------|---------------|
| WRAS_2009 | ACS_20 ACC LY |
|-----------|---------------|



Metal shower hose 1/2" x 3/8" x 68-7/8" - Matte Black

SERIES-VARIOUS

28 322 970    Product version from 4/1/2024

Parts for other  
finishes can be found  
here: [Chrome](#)

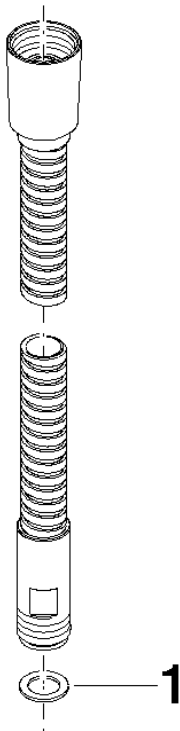

Spare parts list

| Number | Item Number        | Designation | Number of units | Lead time |
|--------|--------------------|-------------|-----------------|-----------|
| 1      | 90 14 20 026 00 90 | seal        | 1.00            | 2         |