

## Showerhead - Brushed Platinum

## SERIES SPECIFIC

28 504 979 Product version from 10/1/2023



- Ø 3-7/8"
- PURIFY RAIN, flow rate max. 1.8 gpm (at 3 bar)
- Function from: gpm
- Descaling system

### Technical dimensions:

- 7-1/8"-8-1/4" Projection
- Ball-joint pivotable through 30°
- Flange diameter 2-1/8"
- 1/2" connection

	Brushed Platinum	28 504 979-06 0010
	Chrome	28 504 979-00 0010
	Platinum	28 504 979-08 0010
	Dark Chrome	28 504 979-19 0010
	Light gold	28 504 979-26 0010
	Brushed Light Gold	28 504 979-27 0010
	Brushed Durabronze (23kt Gold)	28 504 979-28 0010
	Matte Black	28 504 979-33 0010
	Brushed Bronze	28 504 979-42 0010
	Brushed Champagne (22kt Gold)	28 504 979-46 0010
	Champagne (22kt Gold)	28 504 979-47 0010
	Brushed Chrome	28 504 979-93 0010
	Brushed Dark Platinum	28 504 979-99 0010



Showerhead - Brushed Platinum

SERIES SPECIFIC

28 504 979    Product version from 10/1/2023

mm [inches]

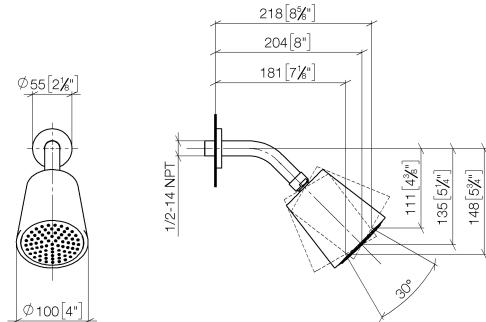

Codes & Standards

ASME A112.18.1      California Energy Commission (CEC)      cUPC      EPA WaterSense

WaterSense



Certificates and sustainability

IAPMO\_4976      IAPMO\_11777

28 504 979    Product version from 10/1/2023

Parts for other  
 finishes can be found  
 here: [Chrome](#)



Spare parts list

Number	Item Number	Designation	Number of units	Lead time
5	90 12 05 054 01-06	shower	1.00	10
3	09 11 03 011-06	connection	1.00	10
2	90 14 10 026 00 90	seal	1.00	2
4	90 14 20 002 00 90	seal	1.00	2
1	09 27 22 503-06	rosette	1.00	10