

Showerhead FlowReduce - Chrome

SERIES SPECIFIC

28 508 979 Product version up to 5/15/2020



- Ø 3-5/8"
- 3-way adjustable: COMPACT RAIN, COMPACT SOFT FLOW, COMPACT AQUAPRESSURE FLOW, flow rate max. 1.8 gpm (at 3 bar)
- Function from: gpm
- Descaling system

Technical dimensions:

- 7-7/8" Projection
- Ball-joint pivotable through 30°
- Flange diameter 2-1/8"
- 1/2" connection

| | | |
|---|--------------------------------|--------------------|
|  | Chrome | 28 508 979-00 0010 |
|  | Brushed Platinum | 28 508 979-06 0010 |
|  | Platinum | 28 508 979-08 0010 |
|  | Dark Chrome | 28 508 979-19 0010 |
|  | Light gold | 28 508 979-26 0010 |
|  | Brushed Light Gold | 28 508 979-27 0010 |
|  | Brushed Durabronze (23kt Gold) | 28 508 979-28 0010 |
|  | Matte Black | 28 508 979-33 0010 |
|  | Brushed Bronze | 28 508 979-42 0010 |
|  | Brushed Champagne (22kt Gold) | 28 508 979-46 0010 |
|  | Champagne (22kt Gold) | 28 508 979-47 0010 |
|  | Brushed Chrome | 28 508 979-93 0010 |
|  | Brushed Dark Platinum | 28 508 979-99 0010 |

28 508 979 Product version up to 5/15/2020

mm [inches]

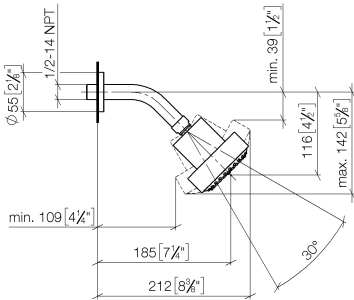

Codes & Standards

| | | | |
|----------------|------------------------------------|-----------|------------|
| ASME A112.18.1 | California Energy Commission (CEC) | cUPC | DIN 4109 |
| EPA WaterSense | ISO 3822 | Ü-Zeichen | WaterSense |



Certificates and sustainability

| | | |
|--------|------------|-------------|
| LGA_38 | IAPMO_4976 | IAPMO_11777 |
|--------|------------|-------------|

28 508 979 Product version up to 5/15/2020

Parts for other
finishes can be found
here: Brushed
Platinum

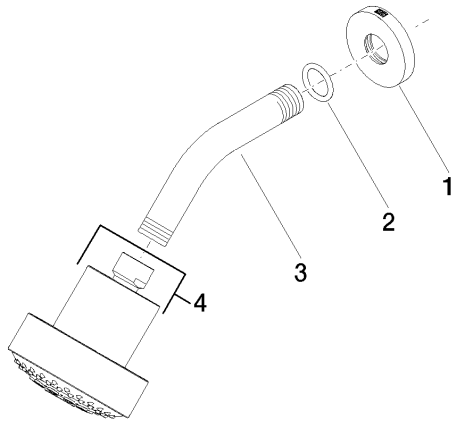

Spare parts list

| Number | Item Number | Designation | Number of units | Lead time |
|--------|--------------------|-------------|-----------------|-----------|
| 1 | 09 27 22 019-00 | rosette | 1.00 | 10 |
| 3 | 09 11 03 011-00 | connection | 1.00 | 10 |
| 4 | 04 12 11 110 30-00 | shower | 1.00 | 10 |
| 2 | 90 14 10 026 00 90 | seal | 1.00 | 2 |