

MADISON Rain shower wall-mounted 7-7/8" - Durabrand (23kt Gold)





MADISON

28 545 977

Product version up to 12/5/2019

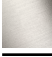

- 17-1/8" Projection
- Rain shower: PURE RAIN, flow rate max. 1.8 gpm (at 3 bar)
- Descaling system
- Rain shower diameter 7-7/8"
- Flange diameter 2-1/8"
- 1/2" connection
- This product reduces water consumption by 28% (compared to requirements of EPA '92)
- This product can help a building meet the requirements of Green Building Rating Systems, e.g. LEED®, BREEAM®, DGNB

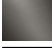
	Durabrand (23kt Gold)	28 545 977-09 0010
	Chrome	28 545 977-00 0010
	Brushed Platinum	28 545 977-06 0010
	Platinum	28 545 977-08 0010
	Brushed Durabrand (23kt Gold)	28 545 977-28 0010
	Brushed Dark Platinum	28 545 977-99 0010

Required article



- Concealed wall elbow -

•Max. rough in depth 6-3/8"

•Min. rough in depth 3-1/2"

35 085 970-90

0010

28 545 977 Product version up to 12/5/2019

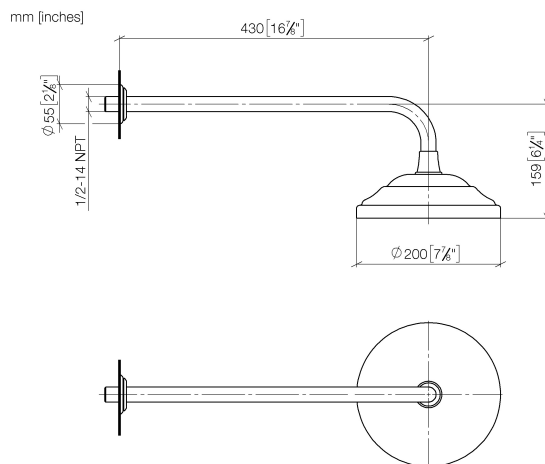

Codes & Standards

ASME A112.18.1 California Energy Commission (CEC) cUPC EPA WaterSense

WaterSense



Certificates and sustainability

IAPMO_4976 IAPMO_11777

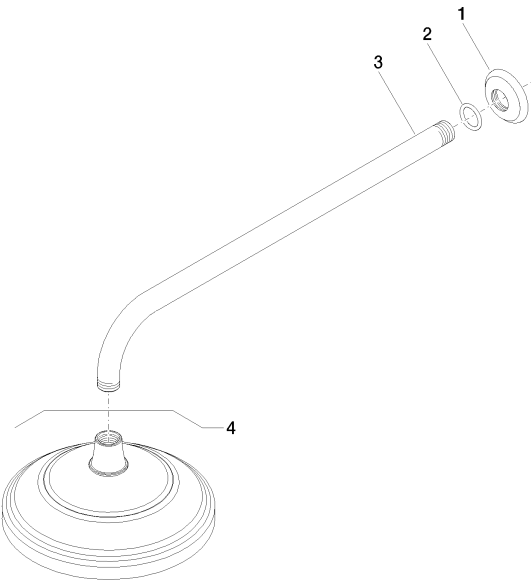

Spare parts list

Number	Item Number	Designation	Number of units	Lead time
	3 09 11 03 017-09	connection	1.00	40
	4 28 535 977-09 0010	shower	1.00	-
Spare part can no longer be ordered, please order the replacement item				
	1 09 27 35 003-09	rosette	1.00	40
	2 90 14 10 026 00 90	seal	1.00	2