

## MADISON Rain shower ceiling-mounted 7-7/8" - Brushed Platinum

MADISON

28 565 977 Product version up to 12/5/2019







- Rain shower diameter 7-7/8"
- PURE RAIN, flow rate max. 1.8 gpm (at 3 bar)
- Descaling system

### Technical dimensions:

- 7-1/4" distance between ceiling and bottom of showerhead
- Flange diameter 2-1/8"
- 1/2" connection

### Notes:

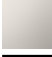
- This product reduces water consumption by 28% (compared to requirements of EPA Act '92)
- This product can help a building meet the requirements of Green Building Rating Systems, e.g. LEED®, BREEAM®, DGNB

|   |                               |                    |
|---|-------------------------------|--------------------|
|  | Brushed Platinum              | 28 565 977-06 0010 |
|  | Chrome                        | 28 565 977-00 0010 |
|  | Platinum                      | 28 565 977-08 0010 |
|  | Durabrand (23kt Gold)         | 28 565 977-09 0010 |
|  | Brushed Durabrand (23kt Gold) | 28 565 977-28 0010 |
|  | Brushed Dark Platinum         | 28 565 977-99 0010 |

### Required article



#### Concealed wall elbow -

- Max. rough in depth 6-3/8"
- Min. rough in depth 3-1/2"

35 085 970-90  
0010



MADISON Rain shower ceiling-mounted 7-7/8" - Brushed Platinum

MADISON

28 565 977    Product version up to 12/5/2019

mm [inches]

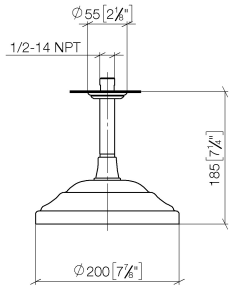

Codes & Standards

|                |   |      |                |
|----------------|---|------|----------------|
| ASME A112.18.1 | California Energy Commission (CEC)  | cUPC | EPA WaterSense |
| WaterSense     |  |      |                |

Certificates and sustainability

|            |             |
|------------|-------------|
| IAPMO_4976 | IAPMO_11777 |
|------------|-------------|

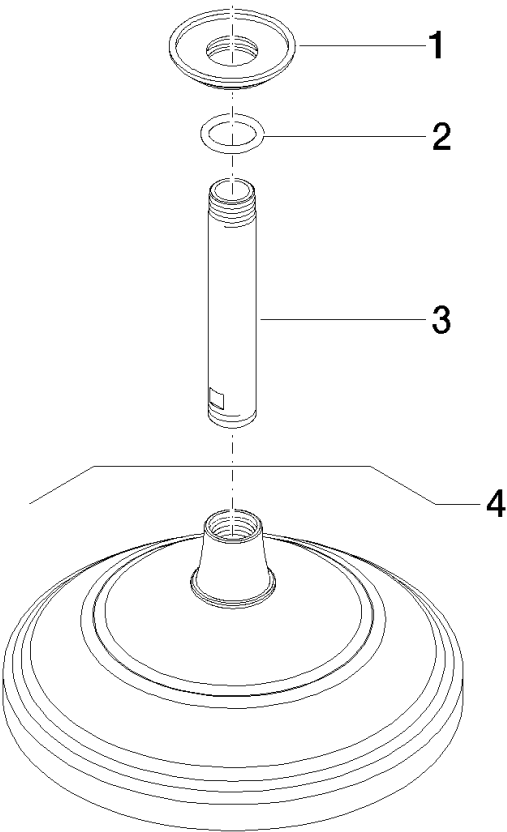

Spare parts list

| Number   | Item Number        | Designation | Number of units | Lead time |
|--|--------------------|-------------|-----------------|-----------|
| 3  | 09 11 03 018-06    | connection  | 1.00            | 10        |
| 1  | 09 27 35 003-06    | rosette     | 1.00            | 10        |
| 4  | 28 535 977-06 0010 | shower      | 1.00            | -         |
| Spare part can no longer be ordered, please order the replacement item |                    |             |                 |           |
| 2  | 90 14 10 026 00 90 | seal        | 1.00            | 2         |