



TARA Two-way diverter for deck-mounted tub installation - Brushed Champagne (22kt Gold)

TARA

29 140 892 Product version from 6/30/2015



- Integrated diverter
 - 1-1/4" hole diameter
 - Flange diameter 2-1/8"
 - 1/2" connection
 - Water flow rate limited to max. 17.1 gpm
- (ADA)

	Brushed Champagne (22kt Gold)	29 140 892-46
	Chrome	29 140 892-00
	Brushed Platinum	29 140 892-06
	Platinum	29 140 892-08
	Dark Chrome	29 140 892-19
	Brushed Durabronze (23kt Gold)	29 140 892-28
	Matte Black	29 140 892-33
	Brushed Dark Brass	29 140 892-39
	Brushed Bronze	29 140 892-42
	Champagne (22kt Gold)	29 140 892-47
	Brushed Chrome	29 140 892-93
	Brushed Dark Platinum	29 140 892-99

TARA Two-way diverter for deck-mounted tub installation - Brushed Champagne (22kt Gold)

TARA

29 140 892 Product version from 6/30/2015
mm [inches]

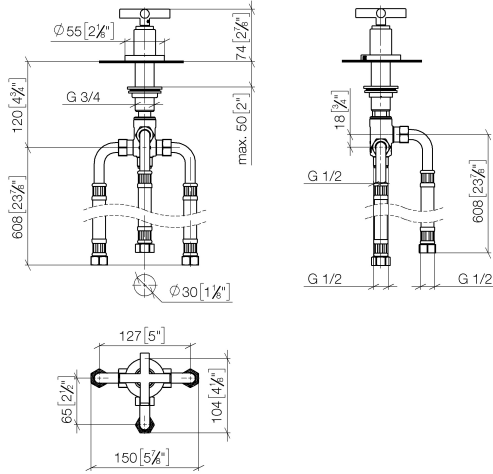

Flow rate chart



Codes & Standards

ASME A112.18.1	California Energy Commission (CEC)	cUPC	DIN 4109
ISO 3822	Ü-Zeichen		



TARA Two-way diverter for deck-mounted tub installation - Brushed Champagne (22kt Gold)

TARA

29 140 892 Product version from 6/30/2015

Certificates and sustainability

LGA_29

IAPMO_4976

TARA Two-way diverter for deck-mounted tub installation - Brushed Champagne (22kt Gold)

TARA

29 140 892 Product version from 6/30/2015

Parts for other
finishes can be found
here: [Chrome](#)

