



VAIA Pillar-tap, wall-mounted cold water only without drain - Brushed Dark Brass

VAIA

30 010 809 Product version from 4/1/2025



- 6" Projection
 - Rigid spout
 - Round aerated stream
 - Adapter, male thread 3/4"
 - 1-3/8" hole diameter
 - Flange diameter 2-3/8"
 - Water flow rate limited to max. 1.2 gpm
 - lead-free
 - This product can help a building meet the requirements of Green Building Rating Systems, e.g. LEED®, BREEAM®, DGNB
- (ADA)

	Brushed Dark Brass	30 010 809-39 0010
	Chrome	30 010 809-00 0010
	Brushed Platinum	30 010 809-06 0010
	Platinum	30 010 809-08 0010
	Dark Chrome	30 010 809-19 0010
	Brushed Durabronze (23kt Gold)	30 010 809-28 0010
	Brushed Bronze	30 010 809-42 0010
	Brushed Champagne (22kt Gold)	30 010 809-46 0010
	Champagne (22kt Gold)	30 010 809-47 0010
	Brushed Dark Platinum	30 010 809-99 0010



VAIA Pillar-tap, wall-mounted cold water only without drain - Brushed Dark Brass

VAIA

30 010 809 Product version from 4/1/2025

mm [inches]

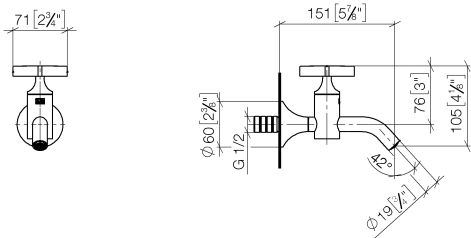

Codes & Standards

ADA	California Energy Commission (CEC)	NSF372	NSF61
-----	------------------------------------	--------	-------

Certificates and sustainability

IAPMO_6397	IAPMO_N-4976
------------	--------------

VAIA Pillar-tap, wall-mounted cold water only without drain - Brushed Dark Brass

VAIA

30 010 809 Product version from 4/1/2025

Parts for other
finishes can be found
here: [Chrome](#)

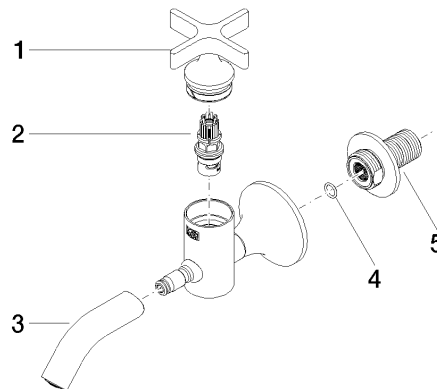

Spare parts list

Number	Item Number	Designation	Number of units	Lead time
4	90 14 10 060 00 90	seal	1.00	2
3	90 28 22 381 01-39	spout	1.00	30
2	90 90 03 175 00 90	top	1.00	2
5	09 24 03 269 90	nipple	1.00	2
1	90 20 66 025 00-39	handle	1.00	30