

## META Single-lever lavatory mixer with extended shank without drain - Matte Black

META

33 534 661 Product version up to 1/23/2020



- 7-7/8" Projection
- Swiveling spout 360°
- Round aerated stream
- Total height 15-5/8"
- Height to aerator/spout outlet 11-3/4"
- 1-3/8" hole diameter
- 2 x pressure hose with 3/8" compression fitting
- Water flow rate limited to max. 1.2 gpm
- lead-free
- This product can help a building meet the requirements of Green Building Rating Systems, e.g. LEED®, BREEAM®, DGNB

(ADA)

For combination with vessel sinks.

	Matte Black	33 534 661-33 0010
	Chrome	33 534 661-00 0010
	Brushed Platinum	33 534 661-06 0010
	Dark Chrome	33 534 661-19 0010
	Light gold	33 534 661-26 0010
	Brushed Light Gold	33 534 661-27 0010
	Brushed Dark Brass	33 534 661-39 0010
	Brushed Bronze	33 534 661-42 0010
	Brushed Champagne (22kt Gold)	33 534 661-46 0010
	Champagne (22kt Gold)	33 534 661-47 0010
	Brushed Chrome	33 534 661-93 0010
	Brushed Dark Platinum	33 534 661-99 0010

# META Single-lever lavatory mixer with extended shank without drain - Matte Black

META

33 534 661 Product version up to 1/23/2020  
mm [inches]

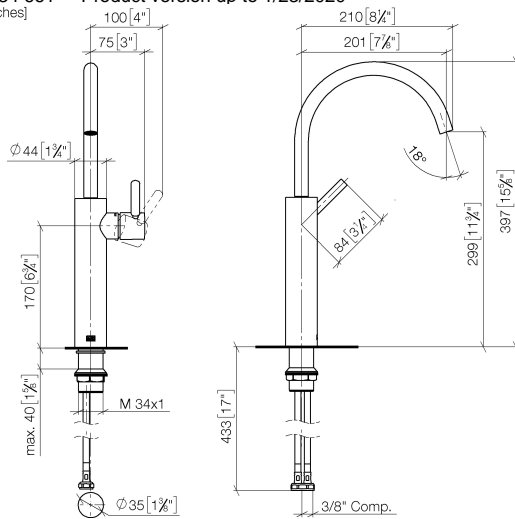

## Codes & Standards

ADA	ASME A112.18.1	California Energy Commission (CEC)	cUPC
EPA WaterSense	NSF372	NSF61	WaterSense



## Certificates and sustainability

IAPMO\_N-4976 IAPMO\_6397 IAPMO\_8834 IAPMO\_4976 (

## META Single-lever lavatory mixer with extended shank without drain - Matte Black

META

33 534 661 Product version up to 1/23/2020

Parts for other  
finishes can be found  
here: [Chrome](#)

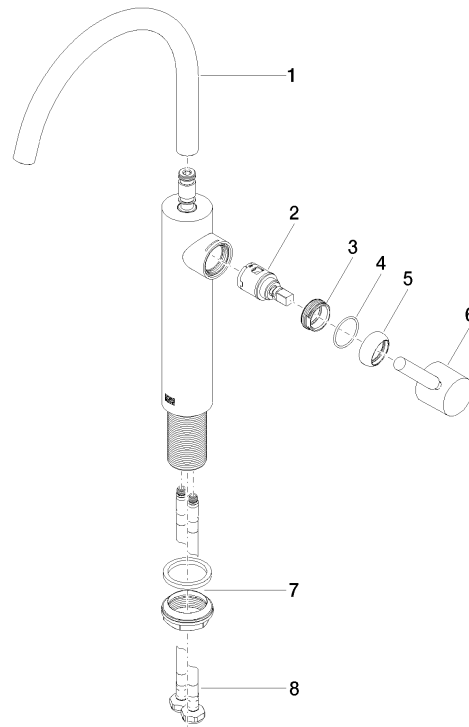

### Spare parts list

Number	Item Number	Designation	Number of units	Lead time
6	90 20 66 003 00-33	handle	1.00	30
5	09 28 30 021-33	cover	1.00	30
7	04 23 10 044 07 90	fixing set	1.00	2
4	09 14 10 091 90	seal	1.00	2
8	04 30 04 103 00 90	hose	2.00	2
3	09 24 04 266 90	nut	1.00	2
2	90 15 05 042 00 90	cartridge	1.00	2
1	90 28 22 313 01-33	spout	1.00	30