

TARA Single-lever mixer - Brushed Champagne (22kt Gold)

TARA

33 815 888 Product version from 9/7/2021



- 9-1/4" Projection
- Swiveling spout 360°
- Aerated stream
- Total height 15-3/4"
- Height to aerator/spout outlet 9"
- 1-3/8" hole diameter
- 2 x pressure hose with 3/8" compression fitting
- Water flow rate limited to max. 1.5 gpm
- lead-free
- This product can help a building meet the requirements of Green Building Rating Systems, e.g. LEED®, BREEAM®, DGNB

(ADA)

Combination with side spray set or profi side spray set not possible.

	Brushed Champagne (22kt Gold)	33 815 888-46 0010
	Chrome	33 815 888-00 0010
	Brushed Platinum	33 815 888-06 0010
	Platinum	33 815 888-08 0010
	Durabass (23kt Gold)	33 815 888-09 0010
	Dark Chrome	33 815 888-19 0010
	Brushed Durabass (23kt Gold)	33 815 888-28 0010
	Matte Black	33 815 888-33 0010
	Brushed Bronze	33 815 888-42 0010
	Champagne (22kt Gold)	33 815 888-47 0010
	Brushed Chrome	33 815 888-93 0010
	Brushed Dark Platinum	33 815 888-99 0010

Recommended article

**Soap dispenser with flange -
Brushed Champagne (22kt Gold)**

82 444 970-46



Recommended article

**AIR SWITCH operating button,
trim parts only - Brushed
Champagne (22kt Gold)**

10 713 970-46



TARA Single-lever mixer - Brushed Champagne (22kt Gold)

TARA

33 815 888 Product version from 9/7/2021

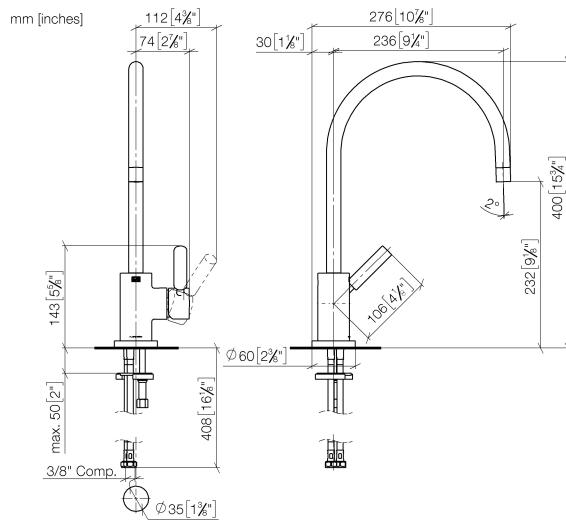

Codes & Standards

ADA	ASME A112.18.1	California Energy Commission (CEC)	cUPC
NSF372	NSF61		

Certificates and sustainability

IAPMO_N-4976 IAPMO_6397 IAPMO_4976 (

TARA Single-lever mixer - Brushed Champagne (22kt Gold)

TARA

33 815 888 Product version from 9/7/2021

Parts for other
finishes can be found
here: [Chrome](#)

