

META Wall mounted two-way diverter - Brushed Bronze

META

36 200 661

Product version from 4/1/2022







- Manual diverter
 - Without flange
 - Handle Ø 2-3/8"
 - with integrated shut-off

(ADA)

Does not allow for simultaneous use of functions

(ADA)

Does not allow for simultaneous use of functions

	Brushed Bronze	36 200 661-42 0010
	Chrome	36 200 661-00 0010
	Brushed Platinum	36 200 661-06 0010
	Light gold	36 200 661-26 0010
	Brushed Light Gold	36 200 661-27 0010
	Matte Black	36 200 661-33 0010
	Brushed Champagne (22kt Gold)	36 200 661-46 0010
	Champagne (22kt Gold)	36 200 661-47 0010
	Brushed Chrome	36 200 661-93 0010
	Brushed Dark Platinum	36 200 661-99 0010

Required article

	Wall mounted two-way diverter -	35 202 970-90
	<ul style="list-style-type: none"> •Min. rough in depth 4-1/2" •Max. rough in depth 6-1/4" 	0010

mm [inches]



Codes & Standards

ADA	ASME A112.18.1	California Energy Commission (CEC)	cUPC
-----	----------------	--	------

Certificates and sustainability

IAPMO_4976 (

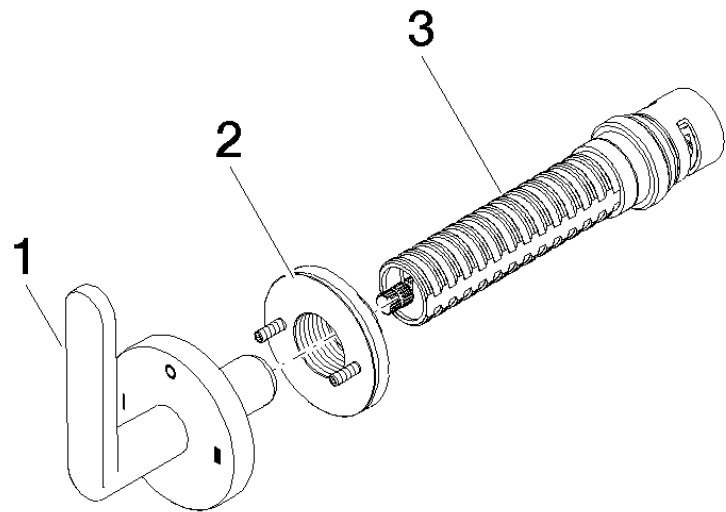

Spare parts list

Number	Item Number	Designation	Number of units	Lead time
2	90 21 02 181 00 90	disc	1.00	2
1	90 20 66 014 01-42	handle	1.00	30
3	90 90 03 306 10 90	diverter	1.00	2