

CL.1 Wall mounted two-way diverter - Brushed Champagne (22kt Gold)

CL.1

36 202 705 Product version from 4/1/2022



- CASCADE structure
 - Manual diverter
 - Flange 2-3/8" x 2-3/8"
 - with integrated shut-off
- (ADA)**
- Does not allow for simultaneous use of functions**
- (ADA)
- Does not allow for simultaneous use of functions

	Brushed Champagne (22kt Gold)	36 202 705-46 0010
	Chrome	36 202 705-00 0010
	Brushed Platinum	36 202 705-06 0010
	Dark Chrome	36 202 705-19 0010
	Champagne (22kt Gold)	36 202 705-47 0010
	Brushed Dark Platinum	36 202 705-99 0010

Required article

	Wall mounted two-way diverter -	35 202 970-90 0010
---	---------------------------------	--------------------



CL.1 Wall mounted two-way diverter - Brushed Champagne (22kt Gold)

CL.1

36 202 705 Product version from 4/1/2022

mm [inches]

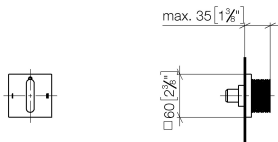

Codes & Standards

ADA	ASME A112.18.1	California Energy Commission (CEC)	cUPC
-----	----------------	------------------------------------	------

Certificates and sustainability

IAPMO_4976 (

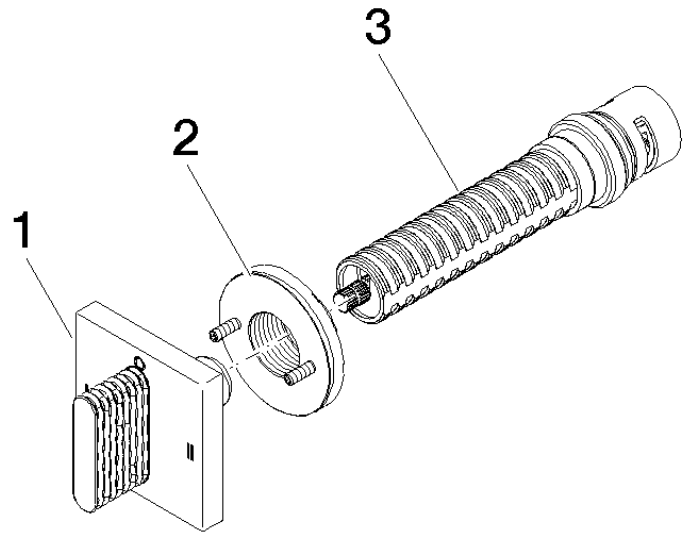

Spare parts list

Number	Item Number	Designation	Number of units	Lead time
2	90 21 02 181 00 90	disc	1.00	2
3	90 90 03 306 10 90	diverter	1.00	2
1	90 20 70 053 09-46	handle	1.00	30