

CL.1 Wall mounted two-way diverter - Brushed Dark Platinum

CL.1

36 202 705    Product version from 4/1/2022



- CASCADE structure
  - Manual diverter
  - Flange 2-3/8" x 2-3/8"
  - with integrated shut-off (ADA)
- Does not allow for simultaneous use of functions**
- (ADA)
- Does not allow for simultaneous use of functions

|   |                               |                    |
|---|-------------------------------|--------------------|
|  | Brushed Dark Platinum         | 36 202 705-99 0010 |
|  | Chrome                        | 36 202 705-00 0010 |
|  | Brushed Platinum              | 36 202 705-06 0010 |
|  | Dark Chrome                   | 36 202 705-19 0010 |
|  | Brushed Champagne (22kt Gold) | 36 202 705-46 0010 |
|  | Champagne (22kt Gold)         | 36 202 705-47 0010 |

Required article

|   |  |               |
|---|--|---------------|
|  | <b>Wall mounted two-way diverter -</b> | 35 202 970-90 |
|   | •Max. rough in depth 6-1/4"            | 0010          |
|   | •Min. rough in depth 4-1/2"            |               |



CL.1 Wall mounted two-way diverter - Brushed Dark Platinum

CL.1

36 202 705    Product version from 4/1/2022

mm [inches]

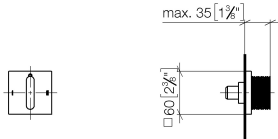

Codes & Standards

|     |                |                                    |      |
|-----|----------------|------------------------------------|------|
| ADA | ASME A112.18.1 | California Energy Commission (CEC) | cUPC |
|-----|----------------|------------------------------------|------|

Certificates and sustainability

IAPMO\_4976 (

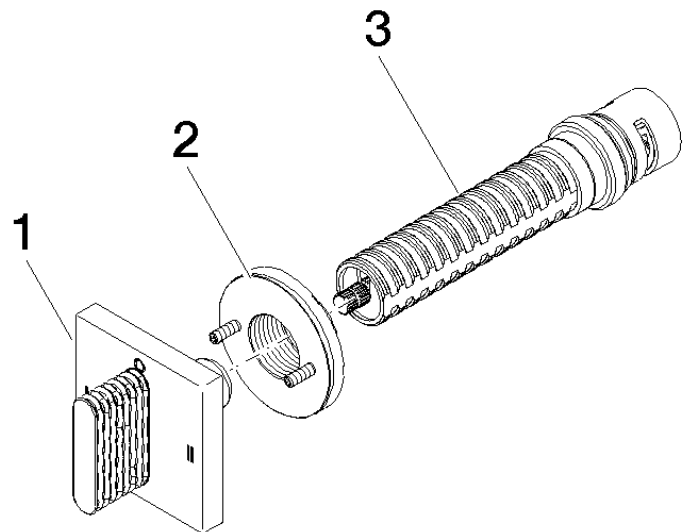

Spare parts list

| Number | Item Number        | Designation | Number of units | Lead time |
|--------|--------------------|-------------|-----------------|-----------|
| 2      | 90 21 02 181 00 90 | disc        | 1.00            | 2         |
| 3      | 90 90 03 306 10 90 | diverter    | 1.00            | 2         |
| 1      | 90 20 70 053 09-99 | handle      | 1.00            | 20        |