







MEM Volume Control clockwise-closing 1/2" - Brushed Durabrass (23kt Gold)

MEM

36 604 782 Product version from 9/1/2022

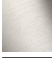

- With hammer blow structure
 - Flange 2-3/8" x 2-3/8"
 - Ceramic disc cartridge
- (ADA)**
- (ADA)

	Brushed Durabrass (23kt Gold)	36 604 782-28
	Chrome	36 604 782-00
	Brushed Platinum	36 604 782-06
	Platinum	36 604 782-08
	Dark Chrome	36 604 782-19
	Brushed Champagne (22kt Gold)	36 604 782-46
	Champagne (22kt Gold)	36 604 782-47
	Brushed Dark Platinum	36 604 782-99

Required article

Rough for volume control 1/2" - 35 607 970-90
0010





MEM Volume Control clockwise-closing 1/2" - Brushed Durabron (23kt Gold)

MEM

36 604 782 Product version from 9/1/2022

mm [inches]



Codes & Standards

ADA	DIN 4109	ISO 3822	Scottish Water Byelaws
UK Water Supply Regulations	Ü-Zeichen		

Certificates and sustainability

WRAS_2011	LGA_29	WRAS_2010
-----------	--------	-----------

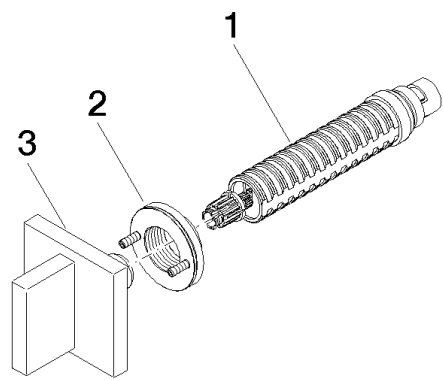

Spare parts list

Number	Item Number	Designation	Number of units	Lead time
2	90 21 02 108 00 90	disc	1.00	2
3	90 20 78 009 02-28	handle	1.00	20
1	90 90 03 143 00 90	top	1.00	2