



MEM Volume Control clockwise-closing 1/2" - Brushed Dark Platinum

MEM

36 604 782 Product version from 9/1/2022



- With hammer blow structure
 - Flange 2-3/8" x 2-3/8"
 - Ceramic disc cartridge
(ADA)
- (ADA)

	Brushed Dark Platinum	36 604 782-99
	Chrome	36 604 782-00
	Brushed Platinum	36 604 782-06
	Platinum	36 604 782-08
	Dark Chrome	36 604 782-19
	Brushed Durabronze (23kt Gold)	36 604 782-28
	Brushed Champagne (22kt Gold)	36 604 782-46
	Champagne (22kt Gold)	36 604 782-47

Required article

Rough for volume control 1/2" - 35 607 970-90 0010





MEM Volume Control clockwise-closing 1/2" - Brushed Dark Platinum

MEM

36 604 782 Product version from 9/1/2022

mm [inches]



Codes & Standards

ADA	ASME A112.18.1	cUPC	DIN 4109
ISO 3822	Scottish Water Byelaws	UK Water Supply Regulations	Ü-Zeichen

Certificates and sustainability

WRAS_2011	LGA_29	WRAS_2010	IAPMO_4976 (
-----------	--------	-----------	--------------

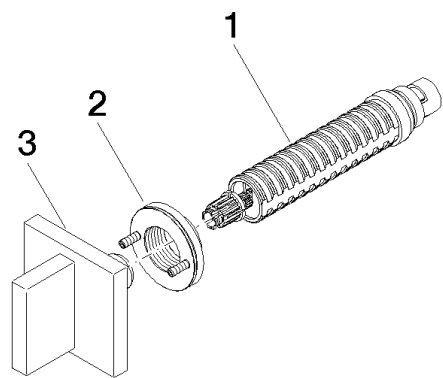

Spare parts list

Number	Item Number	Designation	Number of units	Lead time
1	90 90 03 143 00 90	top	1.00	2
3	90 20 78 009 02-99	handle	1.00	20
2	90 21 02 108 00 90	disc	1.00	2