









CL.1 Volume Control clockwise-closing cold 1/2" - Dark Chrome

CL.1

36 607 706 Product version from 10/14/2020

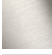

- Flange 2-3/8" x 2-3/8"
  - with marking for cold
  - Ceramic disc cartridge  
**(ADA)**
- (ADA)

|   |                               |               |
|---|-------------------------------|---------------|
|  | Dark Chrome                   | 36 607 706-19 |
|  | Chrome                        | 36 607 706-00 |
|  | Brushed Platinum              | 36 607 706-06 |
|  | Brushed Champagne (22kt Gold) | 36 607 706-46 |
|  | Champagne (22kt Gold)         | 36 607 706-47 |
|  | Brushed Dark Platinum         | 36 607 706-99 |

Required article



- Rough for volume control 1/2" -** 35 607 970-90  
•Max. rough in depth 5-7/8" 0010  
•Min. rough in depth 4-1/8"



CL.1 Volume Control clockwise-closing cold 1/2" - Dark Chrome

CL.1

36 607 706    Product version from 10/14/2020

mm [inches]



Codes & Standards

|          |                        |                             |           |
|----------|------------------------|-----------------------------|-----------|
| ADA      | ASME A112.18.1         | cUPC                        | DIN 4109  |
| ISO 3822 | Scottish Water Byelaws | UK Water Supply Regulations | Ü-Zeichen |

Certificates and sustainability

|        |           |              |
|--------|-----------|--------------|
| LGA_29 | WRAS_2010 | IAPMO_4976 ( |
|--------|-----------|--------------|

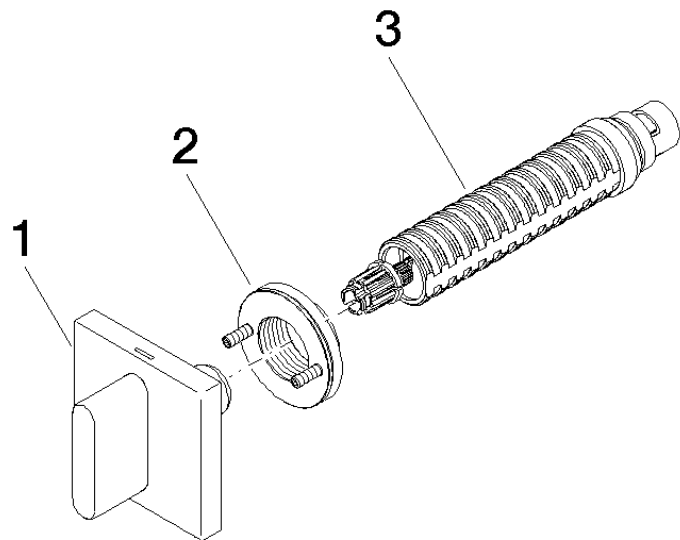

Spare parts list

| Number | Item Number        | Designation     | Number of units | Lead time |
|--------|--------------------|-----------------|-----------------|-----------|
| 2      | 90 21 02 108 00 90 | disc            | 1.00            | 2         |
| 3      | 90 90 03 143 00 90 | top             | 1.00            | 2         |
| 1      | 90 20 70 051 02-19 | handle ( cold ) | 1.00            | 20        |