









CL.1 Volume Control counter-clockwise closing hot 1/2" - Brushed Platinum

CL.1

36 607 707 Product version up to 10/14/2020



- Flange 2-3/8" x 2-3/8"
 - with marking for hot
 - Ceramic disc cartridge
(ADA)
- (ADA)

| | | |
|---|-------------------------------|---------------|
|  | Brushed Platinum | 36 607 707-06 |
|  | Chrome | 36 607 707-00 |
|  | Dark Chrome | 36 607 707-19 |
|  | Brushed Champagne (22kt Gold) | 36 607 707-46 |
|  | Champagne (22kt Gold) | 36 607 707-47 |
|  | Brushed Dark Platinum | 36 607 707-99 |

Required article



- Rough for volume control 1/2" -** 35 607 970-90
•Max. rough in depth 5-7/8" 0010
•Min. rough in depth 4-1/8"



CL.1 Volume Control counter-clockwise closing hot 1/2" - Brushed Platinum

CL.1

36 607 707 Product version up to 10/14/2020

mm [inches]



Codes & Standards

| | | | |
|-----------|----------------|------------------------|-----------------------------|
| ADA | ASME A112.18.1 | cUPC | DIN 4109 |
| EN 200 | ISO 3822 | Scottish Water Byelaws | UK Water Supply Regulations |
| Ü-Zeichen | | | |

Certificates and sustainability

| | | | | |
|-----------------|--------|-----------|--------|--------------|
| DVGW_DW-6501DN0 | LGA_29 | WRAS_2010 | LGA_29 | IAPMO_4976 (|
|-----------------|--------|-----------|--------|--------------|

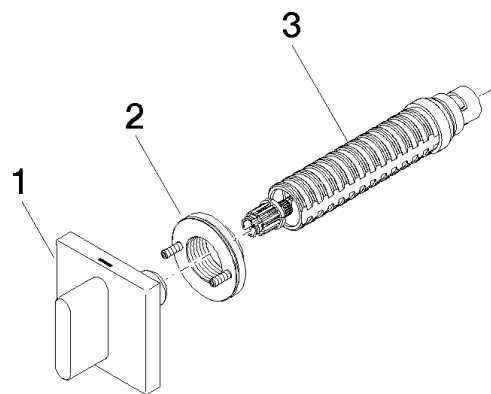

Spare parts list

| Number | Item Number | Designation | Number of units | Lead time |
|--------|--------------------|----------------|-----------------|-----------|
| 1 | 90 20 70 051 03-06 | handle (hot) | 1.00 | 10 |
| 2 | 90 21 02 108 00 90 | disc | 1.00 | 2 |
| 3 | 90 90 03 142 00 90 | top | 1.00 | 2 |