

TARA Volume Control clockwise-closing 1/2" - Dark Chrome
TARA

36 607 892

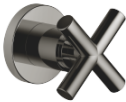

- Flange diameter 2-1/8"
- Ceramic disc cartridge  
**(ADA)**
- (ADA)

	Dark Chrome	36 607 892-19
	Chrome	36 607 892-00
	Brushed Platinum	36 607 892-06
	Platinum	36 607 892-08
	Brushed Durabronze (23kt Gold)	36 607 892-28
	Matte Black	36 607 892-33
	Brushed Bronze	36 607 892-42
	Brushed Champagne (22kt Gold)	36 607 892-46
	Champagne (22kt Gold)	36 607 892-47
	Brushed Chrome	36 607 892-93
	Brushed Dark Platinum	36 607 892-99

Required article



- Rough for volume control 1/2" -**
35 607 970-90
- Max. rough in depth 5-3/4"
  - Min. rough in depth 3-3/8"



TARA Volume Control clockwise-closing 1/2" - Dark Chrome

TARA

36 607 892

mm [inches]

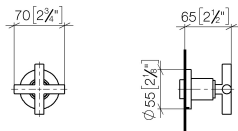

Codes & Standards			
ADA	ASME A112.18.1	cUPC	DIN 4109
EN 1111	EN 200	ISO 3822	Scottish Water Byelaws
UK Water Supply Regulations	Ü-Zeichen		

Certificates and sustainability				
DVGW_DW-6501DN0	WRAS_2011	LGA_29	WRAS_2010	DVGW_DW-6512DN0
IAPMO_4976 (				

36 607 892

