



CL.1 Volume Control counter-clockwise closing hot 1/2" - Brushed Champagne (22kt Gold)





CL.1

36 617 707    Product version from 10/14/2020

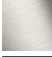

- WAVE structure
- Flange 2-3/8" x 2-3/8"
- with marking for hot
- Ceramic disc cartridge

(ADA)

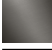
	Brushed Champagne (22kt Gold)	36 617 707-46
	Chrome	36 617 707-00
	Brushed Platinum	36 617 707-06
	Dark Chrome	36 617 707-19
	Champagne (22kt Gold)	36 617 707-47
	Brushed Dark Platinum	36 617 707-99



CL.1 Volume Control counter-clockwise closing hot 1/2" - Brushed Champagne  
(22kt Gold)

CL.1

36 617 707    Product version from 10/14/2020  
mm [inches]



Codes & Standards

ADA	ASME A112.18.1	cUPC	DIN 4109
ISO 3822	Scottish Water Byelaws	UK Water Supply Regulations	Ü-Zeichen

Certificates and sustainability

LGA_29	WRAS_2010	IAPMO_4976 (
--------	-----------	--------------

**CL.1 Volume Control counter-clockwise closing hot 1/2" - Brushed Champagne  
(22kt Gold)**

CL.1

36 617 707    Product version from 10/14/2020  
 Parts for other  
 finishes can be found  
 here: [Chrome](#)

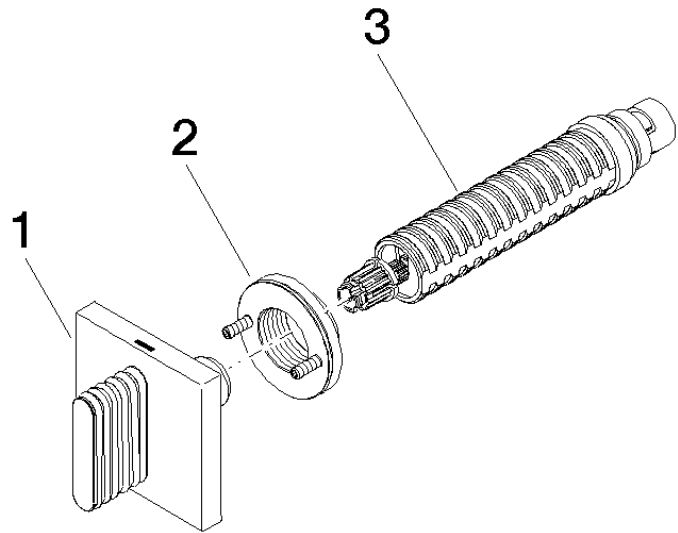

**Spare parts list**

Number	Item Number	Designation	Number of units	Lead time
1	90 20 70 055 03-46	handle ( hot )	1.00	30
2	90 21 02 108 00 90	disc	1.00	2
3	90 90 03 142 00 90	top	1.00	2