



## TARA Wall-mounted three-hole lavatory mixer without drain - Brushed Champagne (22kt Gold)

36 717 882



- 9-1/2" Projection
- Rigid spout
- Round aerated stream
- Valve hole diameter 1-5/8"
- Spout hole diameter 1-5/8"
- Flange diameter 2-1/8"
- Water flow rate limited to max. 1.2 gpm
- lead-free
- This product can help a building meet the requirements of Green Building Rating Systems, e.g. LEED®, BREEAM®, DGNB **(ADA)**

(ADA)

	Brushed Champagne (22kt Gold)	36 717 882-46 0010
	Chrome	36 717 882-00 0010
	Brushed Platinum	36 717 882-06 0010
	Platinum	36 717 882-08 0010
	Dark Chrome	36 717 882-19 0010
	Brushed Durabronze (23kt Gold)	36 717 882-28 0010
	Matte Black	36 717 882-33 0010
	Brushed Bronze	36 717 882-42 0010
	Champagne (22kt Gold)	36 717 882-47 0010
	Brushed Chrome	36 717 882-93 0010
	Brushed Dark Platinum	36 717 882-99 0010

### Required article



**Rough for wall-mounted faucet , spout in center -** 35 700 970-90 0010

- Max. rough in depth "
- Min. rough in depth "

### Required article



**Rough for wall-mounted faucet flexible positioning -** 35 720 970-90 0010

- Max. rough in depth "
- Min. rough in depth "



## TARA Wall-mounted three-hole lavatory mixer without drain - Brushed Champagne (22kt Gold)

---

36 717 882

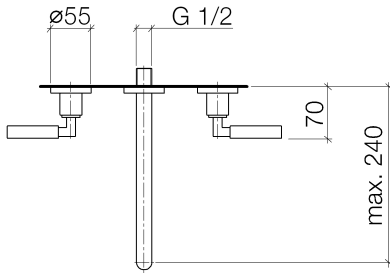
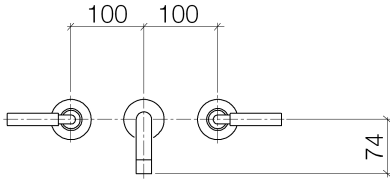

### Codes & Standards

---

ADA

ASME  
A112.18.1/CSA  
B125.1

California Energy  
Commission  
(CEC)

NSF/ANSI 372

NSF/ANSI/CAN  
61

NSF61

### Certificates

---

IAPMO\_N-4976



# TARA Wall-mounted three-hole lavatory mixer without drain - Brushed Champagne (22kt Gold)

36 717 882

