

**Pressure Balance Valve without diverter**

36 900 809



- Cover plate Ø 5-7/8"

|   |                                |               |
|---|--------------------------------|---------------|
|    | Brushed Dark Brass             | 36 900 809-39 |
|    | Chrome                         | 36 900 809-00 |
|    | Brushed Platinum               | 36 900 809-06 |
|    | Platinum                       | 36 900 809-08 |
|    | Dark Chrome                    | 36 900 809-19 |
|    | Brushed Light Gold             | 36 900 809-27 |
|    | Brushed Durabronze (23kt Gold) | 36 900 809-28 |
|    | Brushed Bronze                 | 36 900 809-42 |
|   | Brushed Champagne (22kt Gold)  | 36 900 809-46 |
|  | Champagne (22kt Gold)          | 36 900 809-47 |
|  | Brushed Dark Platinum          | 36 900 809-99 |

**Pressure Balance Valve without diverter**

36 900 809

mm [inches]

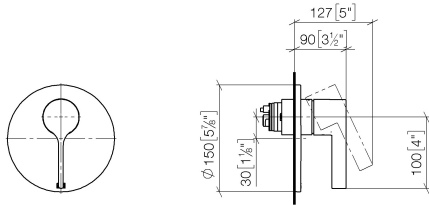

**Flow rate chart**

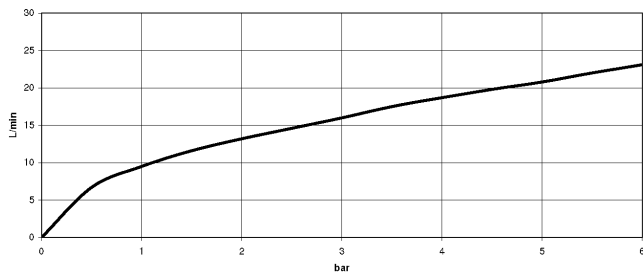

## Pressure Balance Valve without diverter

---

36 900 809

Parts for other  
finishes can be found  
here: [Chrome](#)

