

Lavatory Touchfree Faucet without drain - Chrome

SERIES SPECIFIC

44 521 660 Product version from 10/1/2023



- Infrared sensor technology
- 6-1/2" Projection
- Total height 12-1/4"
- Height to aerator/spout outlet 7-7/8"
- 1-3/8" hole diameter
- Rigid spout
- Water flow rate limited to max. 0.5 gpm
- Laminar stream
- Thermal disinfection
- Automatic shut-off after 30 seconds
- Indirect temperature control (undercounter)
- Control box included
- Adjustable sensor detection range
- Battery or plug-in power supply operated (batteries not included)
- 4x AA (1.5V) batteries required
- lead-free
- 1x 3/8" flexible supply line
- This product can help a building meet the requirements of Green Building Rating Systems, e.g. LEED®, BREEAM®, DGNB

Batteries not included

NOTE: A tempering device is recommended for installation in public areas. Please refer to your local building codes.

| | | |
|---|--------------------------------|--------------------|
|  | Chrome | 44 521 660-00 0010 |
|  | Brushed Platinum | 44 521 660-06 0010 |
|  | Platinum | 44 521 660-08 0010 |
|  | Dark Chrome | 44 521 660-19 0010 |
|  | Light gold | 44 521 660-26 0010 |
|  | Brushed Light Gold | 44 521 660-27 0010 |
|  | Brushed Durabronze (23kt Gold) | 44 521 660-28 0010 |
|  | Brushed Bronze | 44 521 660-42 0010 |
|  | Brushed Champagne (22kt Gold) | 44 521 660-46 0010 |
|  | Champagne (22kt Gold) | 44 521 660-47 0010 |
|  | Brushed Chrome | 44 521 660-93 0010 |
|  | Brushed Dark Platinum | 44 521 660-99 0010 |

Lavatory Touchfree Faucet without drain - Chrome

SERIES SPECIFIC

44 521 660 Product version from 10/1/2023

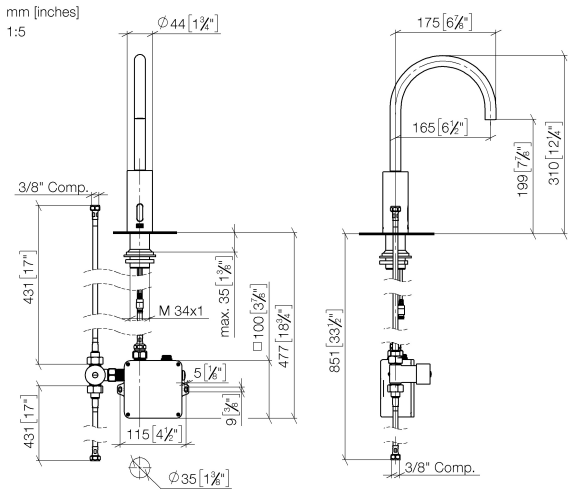

Codes & Standards

| | | | |
|----------------|------------------------------------|------|--------|
| ASME A112.18.1 | California Energy Commission (CEC) | cUPC | NSF372 |
|----------------|------------------------------------|------|--------|

Certificates and sustainability

IAPMO_6397 IAPMO_4976 (

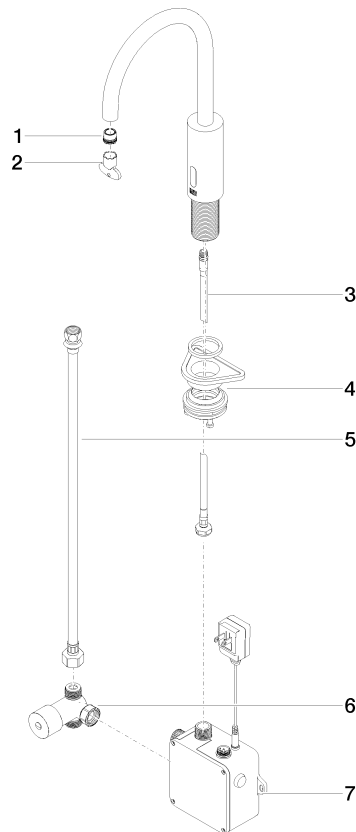

Spare parts list

| Number | Item Number | Designation | Number of units | Lead time |
|--------|--------------------|-----------------------|-----------------|-----------|
| 7 | 90 10 01 247 02 90 | valve box | 1.00 | 60 |
| 1 | 09 29 03 094 90 | aerator | 1.00 | 2 |
| 5 | 12 506 970 90 | High pressure hoses - | 1.00 | 2 |
| 4 | 04 23 10 044 08 90 | fixing set | 1.00 | 2 |
| 6 | 90 30 50 081 00 90 | valve | 1.00 | 2 |
| 3 | 04 30 04 108 00 90 | hose | 1.00 | 60 |
| 2 | 90 30 09 028 00 90 | key | 1.00 | 2 |