

Lavatory Touchfree Faucet without drain - Brushed Platinum

SERIES SPECIFIC

44 521 660 Product version from 10/1/2023



- Infrared sensor technology
 - 6-1/2" Projection
 - Total height 12-1/4"
 - Height to aerator/spout outlet 7-7/8"
 - 1-3/8" hole diameter
 - Rigid spout
 - Water flow rate limited to max. 0.5 gpm
 - Laminar stream
 - Thermal disinfection
 - Automatic shut-off after 30 seconds
 - Indirect temperature control (undercounter)
 - Control box included
 - Adjustable sensor detection range
 - Battery or plug-in power supply operated (batteries not included)
 - 4x AA (1.5V) batteries required
 - lead-free
 - 1x 3/8" flexible supply line
 - This product can help a building meet the requirements of Green Building Rating Systems, e.g. LEED®, BREEAM®, DGNB
- Batteries not included
- NOTE: A tempering device is recommended for installation in public areas. Please refer to your local building codes.

	Brushed Platinum	44 521 660-06 0010
	Chrome	44 521 660-00 0010
	Platinum	44 521 660-08 0010
	Dark Chrome	44 521 660-19 0010
	Light gold	44 521 660-26 0010
	Brushed Light Gold	44 521 660-27 0010
	Brushed Durabronze (23kt Gold)	44 521 660-28 0010
	Brushed Bronze	44 521 660-42 0010
	Brushed Champagne (22kt Gold)	44 521 660-46 0010
	Champagne (22kt Gold)	44 521 660-47 0010
	Brushed Chrome	44 521 660-93 0010
	Brushed Dark Platinum	44 521 660-99 0010

Lavatory Touchfree Faucet without drain - Brushed Platinum

SERIES SPECIFIC

44 521 660 Product version from 10/1/2023

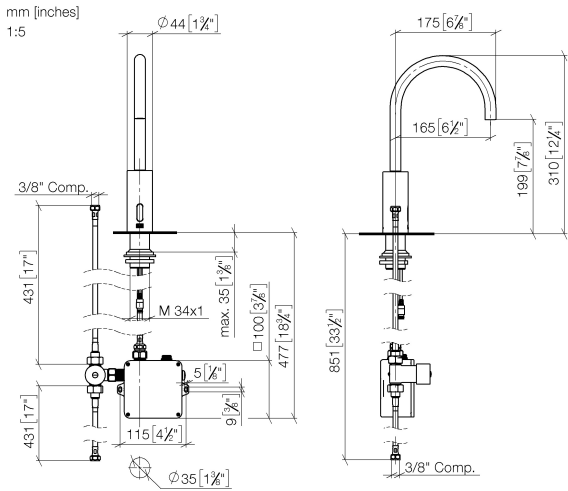

Codes & Standards

ASME A112.18.1	California Energy Commission (CEC)	cUPC	NSF372
----------------	------------------------------------	------	--------

Certificates and sustainability

IAPMO_6397 IAPMO_4976 (

44 521 660 Product version from 10/1/2023

Parts for other
finishes can be found
here: [Chrome](#)

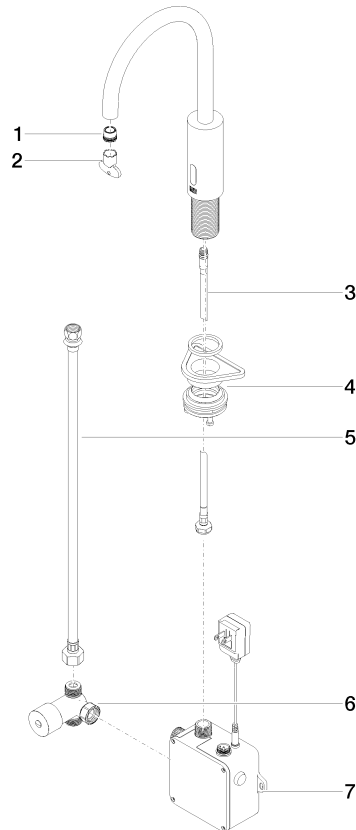

Spare parts list

Number	Item Number	Designation	Number of units	Lead time
7	90 10 01 247 02 90	valve box	1.00	60
1	09 29 03 094 90	aerator	1.00	2
5	12 506 970 90	High pressure hoses -	1.00	2
6	90 30 50 081 00 90	valve	1.00	2
4	04 23 10 044 08 90	fixing set	1.00	2
3	04 30 04 108 00 90	hose	1.00	60
2	90 30 09 028 00 90	key	1.00	2