









Tissue holder - Chrome

SERIES SPECIFIC

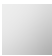
83 525 976 Product version from 4/1/2024



- Center to center 9"
- Width 11-1/4"
- Height: 2-7/8 mm
- 4" Projection

	Chrome	83 525 976-00
	Brushed Platinum	83 525 976-06
	Dark Chrome	83 525 976-19
	Brushed Light Gold	83 525 976-27
	Brushed Chrome	83 525 976-93
	Brushed Dark Platinum	83 525 976-99

83 525 976 Product version from 4/1/2024

mm [inches]

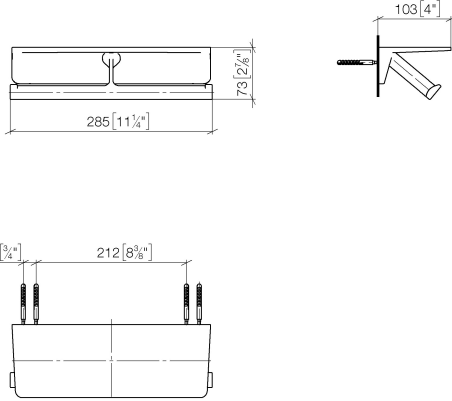

83 525 976 Product version from 4/1/2024

Parts for other
finishes can be found
here: Brushed
Platinum

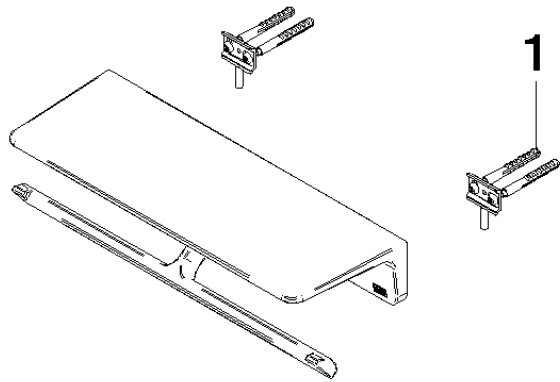

Spare parts list

Number	Item Number	Designation	Number of units	Lead time
1	90 30 30 242 00 90	fixing set	2.00	2