



**CL.1 Wall-mounted basin spout without pop-up waste - Brushed Platinum**

CL.1

13 800 705

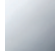
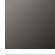
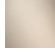

- 200mm projection
- fixed spout
- rectangular spray pattern with 40 individual jets
- hole diameter 37 mm
- lead-free
- 1/2" connection
- plug-link mounting
- max. flow 4.5 l/min
- This product can help a building meet the requirements of Green Building Rating Systems, e.g. LEED®, BREEAM®, DGNB

	Brushed Platinum	13 800 705-06
	Chrome	13 800 705-00
	Dark Chrome	13 800 705-19
	Brushed Champagne (22kt Gold)	13 800 705-46
	Champagne (22kt Gold)	13 800 705-47
	Brushed Dark Platinum	13 800 705-99

**Required miscellaneous**

**Concealed adapter -**

35 080 970-90  
0010



13 800 705

mm [inches]

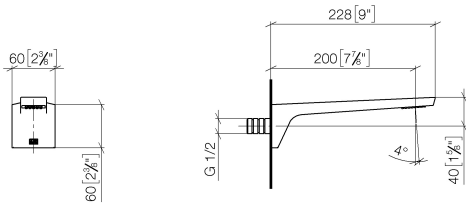

Flow rate chart



## Codes & Standards

ASME  
A112.18.1/CSA  
B125.1

Water Sense



California Energy  
Commission  
(CEC)

NSF/ANSI 372

NSF/ANSI/CAN  
61



CL.1 Wall-mounted basin spout without pop-up waste - Brushed Platinum

CL.1

13 800 705

Certificates

LGA\_28685. IAPMO\_N-4976. IAPMO\_8834 (1). IAPMO\_4976 (6). WRAS\_1512013.  
IAPMO\_6397.

13 800 705

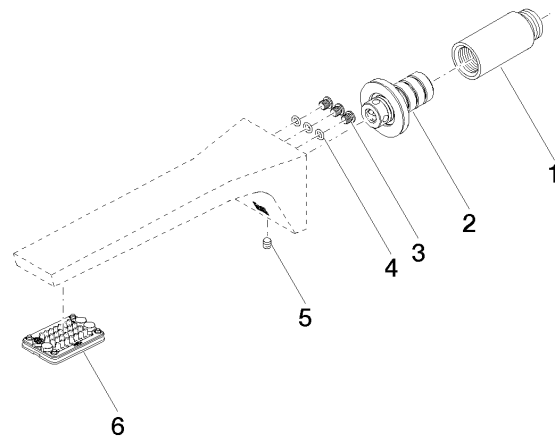

### Spare parts list

No.	Item Number	Name	Quantity used	Delivery time
1	09 24 03 081 10 90	extension	1	2
2	90 24 03 108 01 90	nipple set	1	2
3	09 30 30 113 20 90	screw	3	2
4	09 14 10 001 90	seal	3	2
5	90 31 11 004 00 90	pin	1	2
6	90 11 02 297 00 90	aerator	1	2