

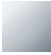

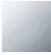

CL.1 Wall-mounted basin spout without pop-up waste - Brushed Champagne (22kt Gold)

CL.1

13 800 705			
	<ul style="list-style-type: none"> • 200mm projection • fixed spout • rectangular spray pattern with 40 individual jets • hole diameter 37 mm • lead-free • 1/2" connection • plug-link mounting • max. flow 4.5 l/min • This product can help a building meet the requirements of Green Building Rating Systems, e.g. LEED®, BREEAM®, DGNB 	 <div>Brushed Champagne (22kt Gold)</div>	13 800 705-46
			Chrome13 800 705-00
			Brushed Platinum13 800 705-06
			Dark Chrome13 800 705-19
			Champagne (22kt Gold)13 800 705-47
			Brushed Dark Platinum13 800 705-99

CL.1 Wall-mounted basin spout without pop-up waste - Brushed Champagne (22kt Gold)

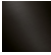
CL.1

13 800 705
mm [inches]



Flow rate chart



Codes & Standards

ASME
A112.18.1/CSA
B125.1

California Energy
Commission
(CEC)

NSF/ANSI 372

NSF/ANSI/CAN
61



CL.1 Wall-mounted basin spout without pop-up waste - Brushed Champagne (22kt Gold)

CL.1

13 800 705

Certificates

IAPMO_N-4976.

IAPMO_6397.

CL.1 Wall-mounted basin spout without pop-up waste - Brushed Champagne (22kt Gold)

CL.1

13 800 705
Parts for other
finishes can be found
here: [Chrome](#)

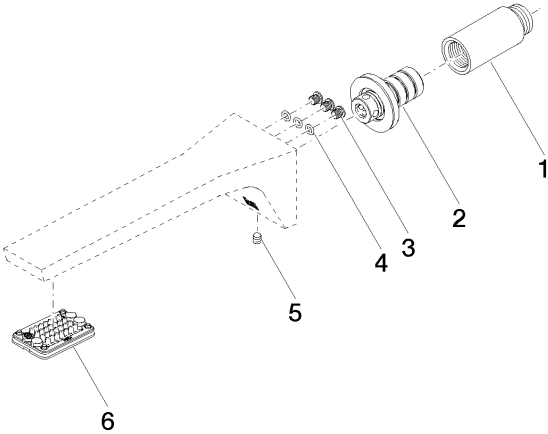

Spare parts list

No.	Item Number	Name	Quantity used	Delivery time
1	09 24 03 081 10 90	extension	1	2
2	90 24 03 108 01 90	nipple set	1	2
3	09 30 30 113 20 90	screw	3	2
4	09 14 10 001 90	seal	3	2
5	90 31 11 004 00 90	pin	1	2
6	90 11 02 297 00 90	aerator	1	2