







LISSÉ Bath spout for wall mounting - Matte Black

LISSÉ

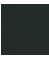
13 801 845



- 210mm projection
- circular normal flow
- hole diameter 37 mm
- 1/2" connection
- plug-link mounting
- max. flow 21.5 l/min at 3 bar flow pressure
- WRAS 2207003

	Matte Black	13 801 845-33
	Chrome	13 801 845-00
	Brushed Platinum	13 801 845-06
	Dark Chrome	13 801 845-19
	Brushed Chrome	13 801 845-93
	Brushed Dark Platinum	13 801 845-99

Required miscellaneous

Concealed adapter -

35 080 970-90
0010



13 801 845

mm [inches]

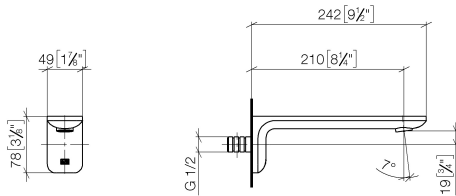

Flow rate chart

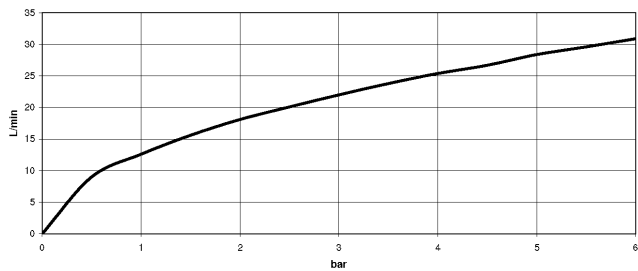

Codes & Standards

ASME A112.18.1/CSA B125.1	DIN 4109	ISO 3822	Scottish Water Byelaws
UK Water Supply Regulations	Ü-Zeichen		



LISSÉ Bath spout for wall mounting - Matte Black

LISSÉ

13 801 845

Certificates

LGA_29

WRAS_2207

Product version from 3/9/2016

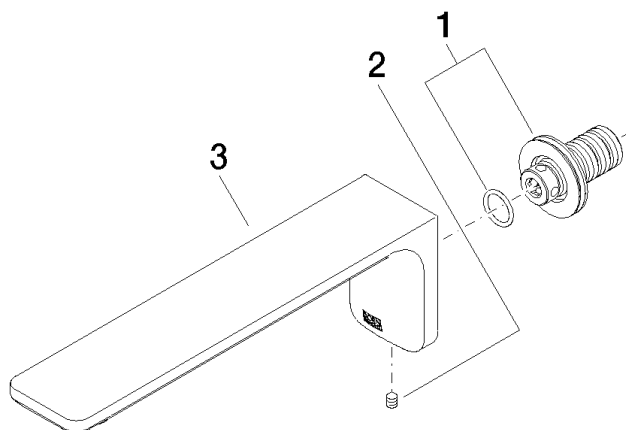



LISSE Bath spout for wall mounting - Matte Black

LISSE

13 801 845

Spare parts list

Product version from 3/9/2016

No.	Item Number	Name	Quantity used	Delivery time
	90 24 03 108 00 90	nipple set	3	2